



### 45 Penfold Road ELIZABETH SOUTH SA

3  1  3 

To submit an offer, please copy and paste this link into your browser: <https://airtable.com/shrBb12PXtTjyZAXm>

Jake Halliday and Edge Realty are proud to present to the market this three-bedroom, one-bathroom property crafted for easy-care living, making the ideal first home, comfortable family abode or quality investment. Everything you need for a contemporary life of convenience is perfectly positioned only moments from your door while at home, the good-size block ensures there's room to spread out and relax.

The entry opens to reveal a light-filled and air-conditioned lounge room with low-maintenance tile flooring underfoot. From here, you can flow easily through to the open-plan kitchen and meals area while fresh paint ensures a bright, modern and inviting feel to the interior.

**Price** : \$ 209,000  
**Land Size** : 538 sqm  
**View** : <https://www.edgerealty.com.au/sale/sa/north-north-east-suburbs/elizabeth-south/residential/house/6453775>

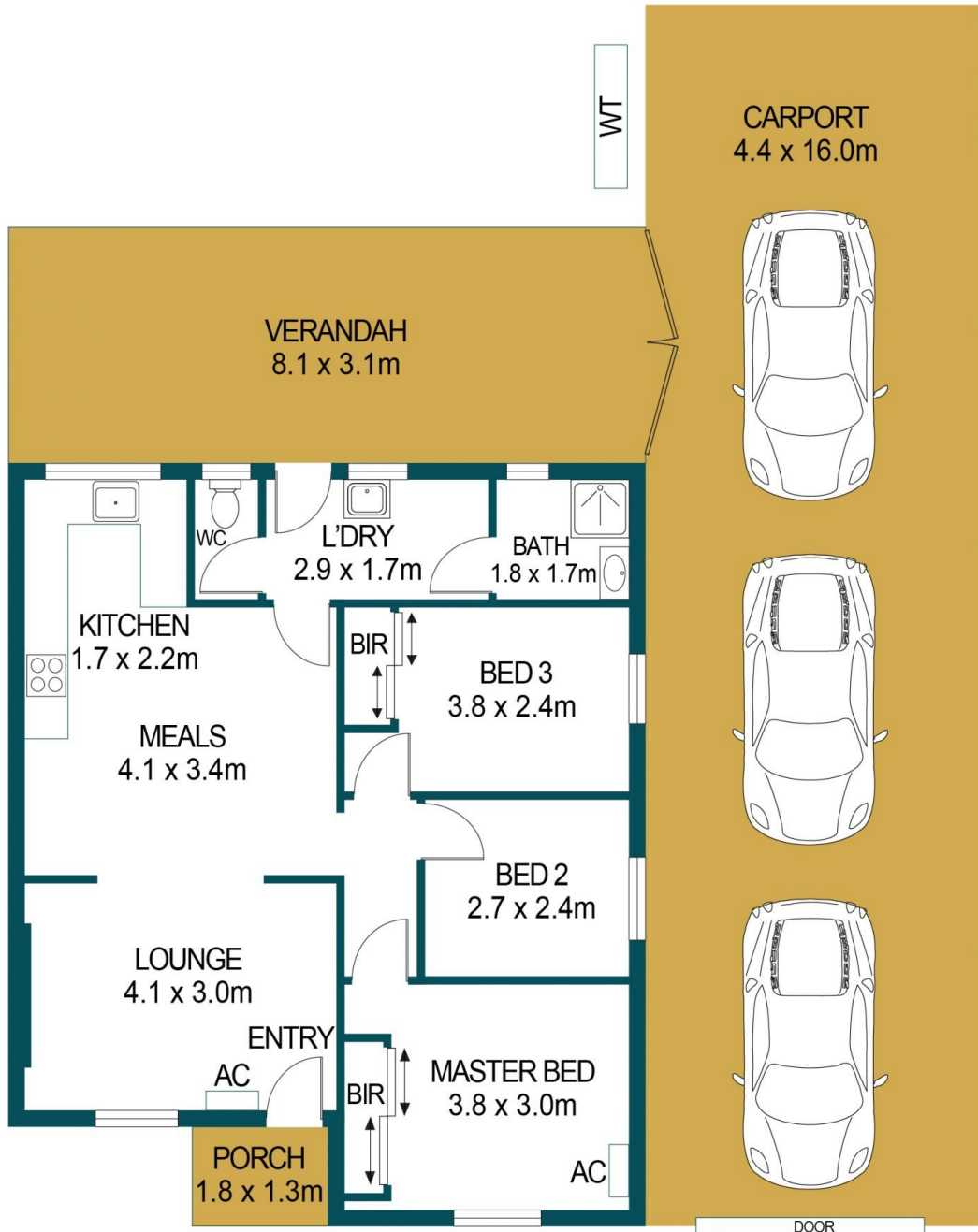

APPROXIMATE DIMENSIONS

|           |                     |
|-----------|---------------------|
| LIVING:   | 70.4m <sup>2</sup>  |
| PORCH:    | 2.3m <sup>2</sup>   |
| VERANDAH: | 25.1m <sup>2</sup>  |
| CARPORT:  | 70.4m <sup>2</sup>  |
| TOTAL:    | 168.2m <sup>2</sup> |

## 45 PENFOLD ROAD, ELIZABETH SOUTH

DISCLAIMER

PLANS SHOWN ARE FOR MARKETING PURPOSES ONLY, ALL DIMENSIONS ARE APPROXIMATE AND NOT TO SCALE. THEY ARE SUBJECT TO ERRORS AND INACCURACIES AND NO LIABILITY WILL BE ACCEPTED. INTERESTED PARTIES SHOULD MAKE THEIR OWN ENQUIRIES.



IMAGES AND FLOORPLAN BY:  
**IN-HOUSE**  
IMAGING  
inhouseimaging.com.au