



**15/103 The Golden Way WYNN VALE SA**

3 1 1

\*For an in-depth look at this home, please click on the 3D tour for a virtual walk-through\*

Virtual Tour Link: <https://my.matterport.com/show/?m=fpQ7TSQa3Jf>

To submit an offer, please copy and paste this link into your browser: <https://airtable.com/shrBb12PXtTjyZAXm>

Andrew Farnworth and Edge Realty are proud to present to the market this exciting opportunity to enjoy easy-care, spacious and comfortable living. There will be no shortage of first-time buyers, young families or astute investors eager to get their hands on this impressive townhouse.

From the covered porch, you are welcomed inside where a light-filled lounge room awaits complete with on-trend floating floors and a large window that frames views over

**Price** : \$ 325,000  
**Building Size** : 90 sqm  
**Land Size** : 129 sqm  
**View** : <https://www.edgerealty.com.au/sale/sa/north-north-east-suburbs/wynn-vale/residential/townhouse/6493073>



**Mike Lao**  
0410390250



**Tom Dunstan**  
0429656820

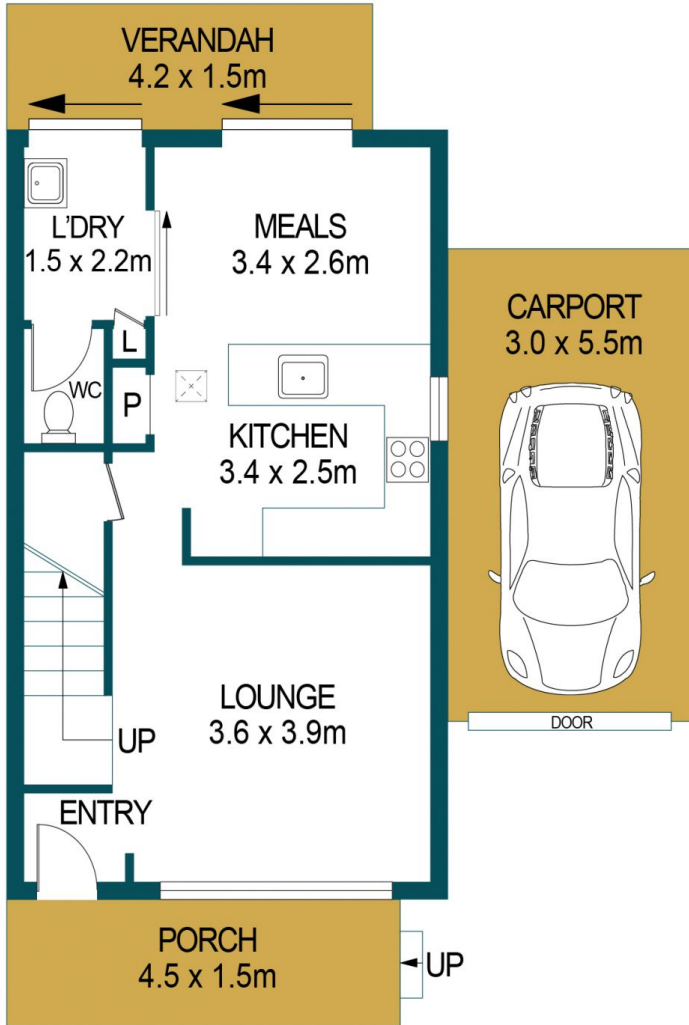

GROUND FLOOR

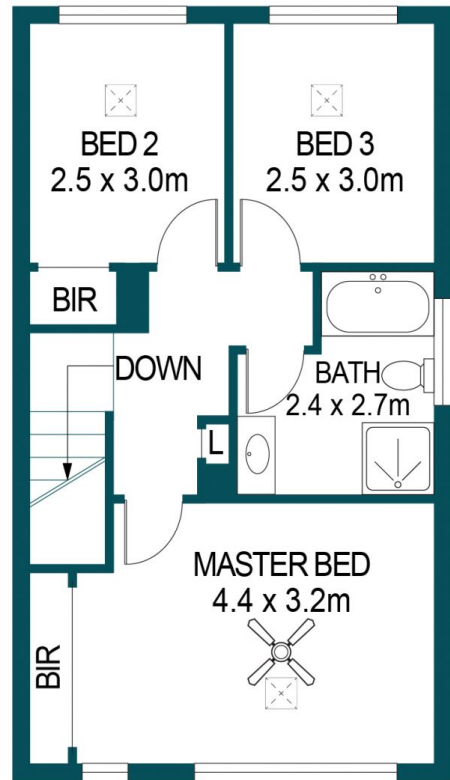

FIRST FLOOR

## 15/103 THE GOLDEN WAY, WYNN VALE

### APPROXIMATE DIMENSIONS

LIVING:	90.5m <sup>2</sup>
PORCH:	6.7m <sup>2</sup>
VERANDAH:	6.3m <sup>2</sup>
CARPOT:	16.5m <sup>2</sup>
TOTAL:	120.0m <sup>2</sup>

### DISCLAIMER

PLANS SHOWN ARE FOR MARKETING PURPOSES ONLY, ALL DIMENSIONS ARE APPROXIMATE AND NOT TO SCALE. THEY ARE SUBJECT TO ERRORS AND INACCURACIES AND NO LIABILITY WILL BE ACCEPTED. INTERESTED PARTIES SHOULD MAKE THEIR OWN ENQUIRIES.



IMAGES AND FLOORPLAN BY:  
**IN-HOUSE**  
IMAGING  
inhouseimaging.com.au