



30 Bartlett Street ELIZABETH DOWNS SA

2 1 1

To submit an offer, please copy and paste this link into your browser: <https://airtable.com/shrBb12PXtTjyZAXm>

Mike Lao, Corey Wilkop and Edge Realty RLA256385 are proud to present to the market this true renovator's delight. There is so much scope to improve this property and create an idyllic family abode or perhaps you're simply looking to make some updates and offer the home for rent, the choice is all yours.

Step inside, where the layout offers two bedrooms and one bathroom along with a host of charming features throughout. There's a good-size lounge with air-conditioning and a fireplace while the kitchen is large enough to accommodate a dining area for casual meals.

The laundry and bathroom, with a separate toilet, is located

Price : \$ 186,000
Building Size : 75 sqm
Land Size : 491 sqm
View : <https://www.edgerealty.com.au/sale/sa/north-north-east-suburbs/elizabeth-downs/residential/house/6845635>



Mike Lao
0410390250



Tyson Bennett
0437161997

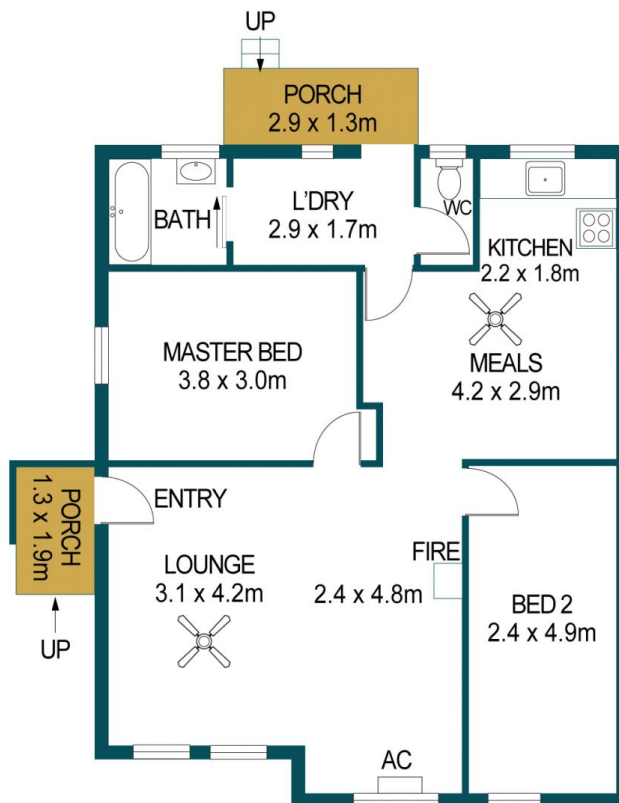
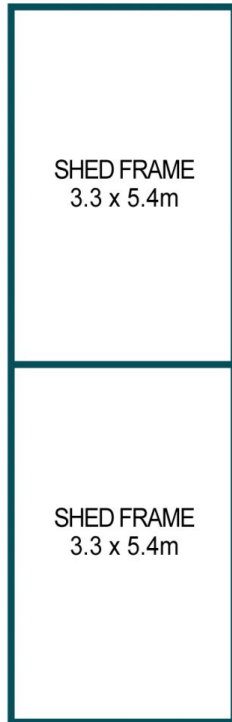

APPROXIMATE DIMENSIONS

LIVING:	75.3m ²
SHED:	35.6m ²
PORCH:	6.2m ²
TOTAL:	117.1m ²

30 BARTLETT STREET, ELIZABETH DOWNS

DISCLAIMER

PLANS SHOWN ARE FOR MARKETING PURPOSES ONLY, ALL DIMENSIONS ARE APPROXIMATE AND NOT TO SCALE. THEY ARE SUBJECT TO ERRORS AND INACCURACIES AND NO LIABILITY WILL BE ACCEPTED. INTERESTED PARTIES SHOULD MAKE THEIR OWN ENQUIRIES.



IMAGES AND FLOORPLAN BY:
IN-HOUSE
IMAGING
inhouseimaging.com.au