



**48 Ashfield Road ELIZABETH SA**

3 1 1

To submit an offer, please copy and paste this link into your browser: <https://airtable.com/shrBb12PXtTjyZAXm>

Mike Lao, Tyson Bennett and Edge Realty RLA256385 are proud to present to the market a 790sqm block ready and waiting for you to make it your own. Perfectly located for ease and convenience this three-bedroom home has a charming historic appeal perfectly suited to the first home buyer, or as an easy-care retreat which is ready to move in and enjoy, renovate or as an investment property to add to the portfolio for excellent returns.

The welcoming covered veranda at the entrance to the home has a view over the fully fenced front yard. Inside, you'll find three bedrooms and one bathroom, with air-conditioning to the lounge and ceiling fan in the large master bedroom for year-round comfort.

**Price** : \$ 290,000  
**Building Size** : 91 sqm  
**Land Size** : 790 sqm  
**View** : <https://www.edgerealty.com.au/sale/sa/north-north-east-suburbs/elizabeth/residential/house/6847719>



**Mike Lao**  
0410390250



**Tyson Bennett**  
0437161997

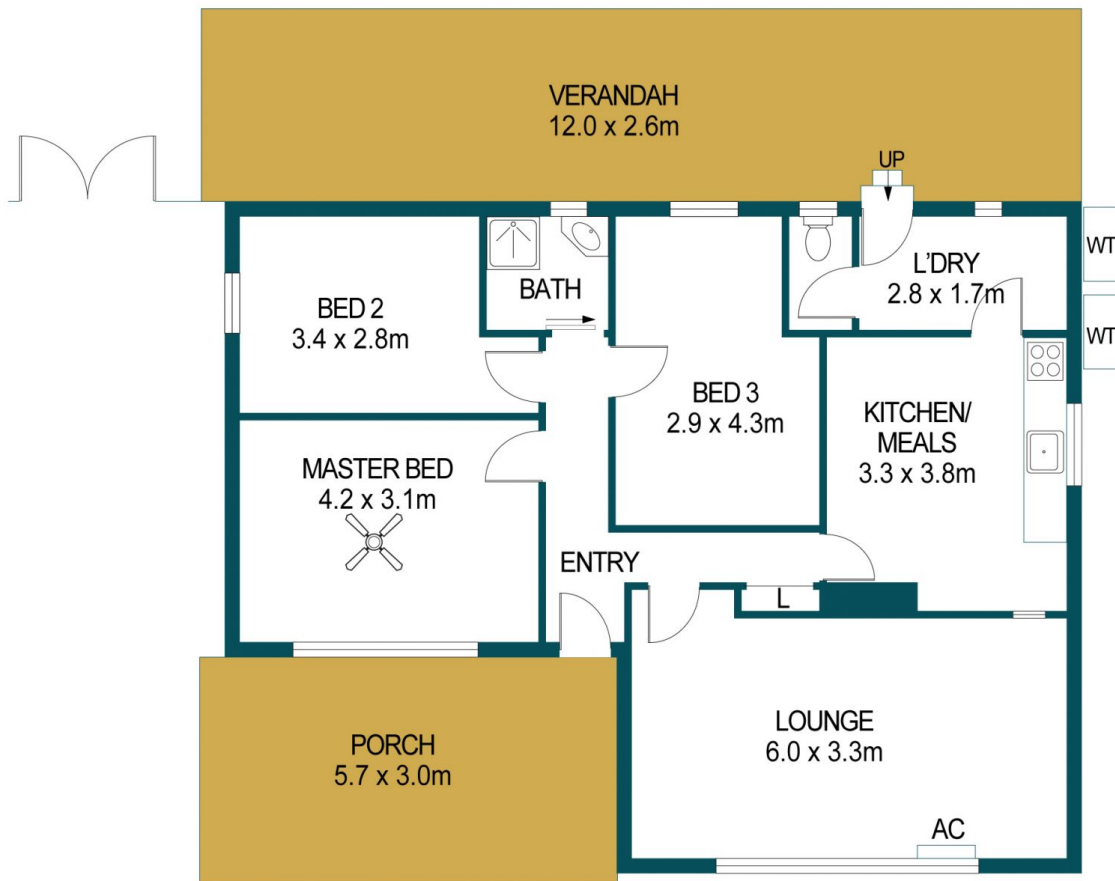
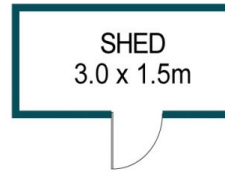
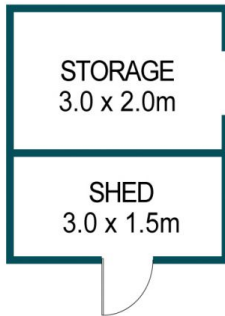

APPROXIMATE DIMENSIONS	
LIVING:	91.4m <sup>2</sup>
VERANDAH:	31.2m <sup>2</sup>
PORCH:	17.1m <sup>2</sup>
SHED:	9.0m <sup>2</sup>
STORAGE:	6.0m <sup>2</sup>
TOTAL:	154.7m <sup>2</sup>

## 48 ASHFIELD ROAD, ELIZABETH

### DISCLAIMER

PLANS SHOWN ARE FOR MARKETING PURPOSES ONLY, ALL DIMENSIONS ARE APPROXIMATE AND NOT TO SCALE. THEY ARE SUBJECT TO ERRORS AND INACCURACIES AND NO LIABILITY WILL BE ACCEPTED. INTERESTED PARTIES SHOULD MAKE THEIR OWN ENQUIRIES.



IMAGES AND FLOORPLAN BY:  
**IN-HOUSE**  
IMAGING  
inhouseimaging.com.au