



## 24 Sandford Road DAVOREN PARK SA

3 1 2

To submit an offer, please copy and paste this link into your browser: <https://airtable.com/shrBb12PXtTjyZAXm>

Mike Lao, Corey Wilkop and Edge Realty RLA256385 are proud to present to the market this three-bedroom solid brick family home in Davoren Park where comfort and charm meet unlimited future potential. This 685sqm corner block is ideally located with park and playground just across the road and could offer the idyllic family home you've always wanted.

The choice is all yours, whether you wish to move in and enjoy this property as-is or look to make some updates, add your own personal style and create the modern home of your dreams (STCA).

Established landscaped gardens greet you on arrival to the

**Price** : \$ 320,000  
**Building Size** : 96 sqm  
**Land Size** : 650 sqm  
**View** : <https://www.edgerealty.com.au/sale/sa/north-north-east-suburbs/davoren-park/residential/house/6855173>



**Mike Lao**  
0410390250



**Tyson Bennett**  
0437161997

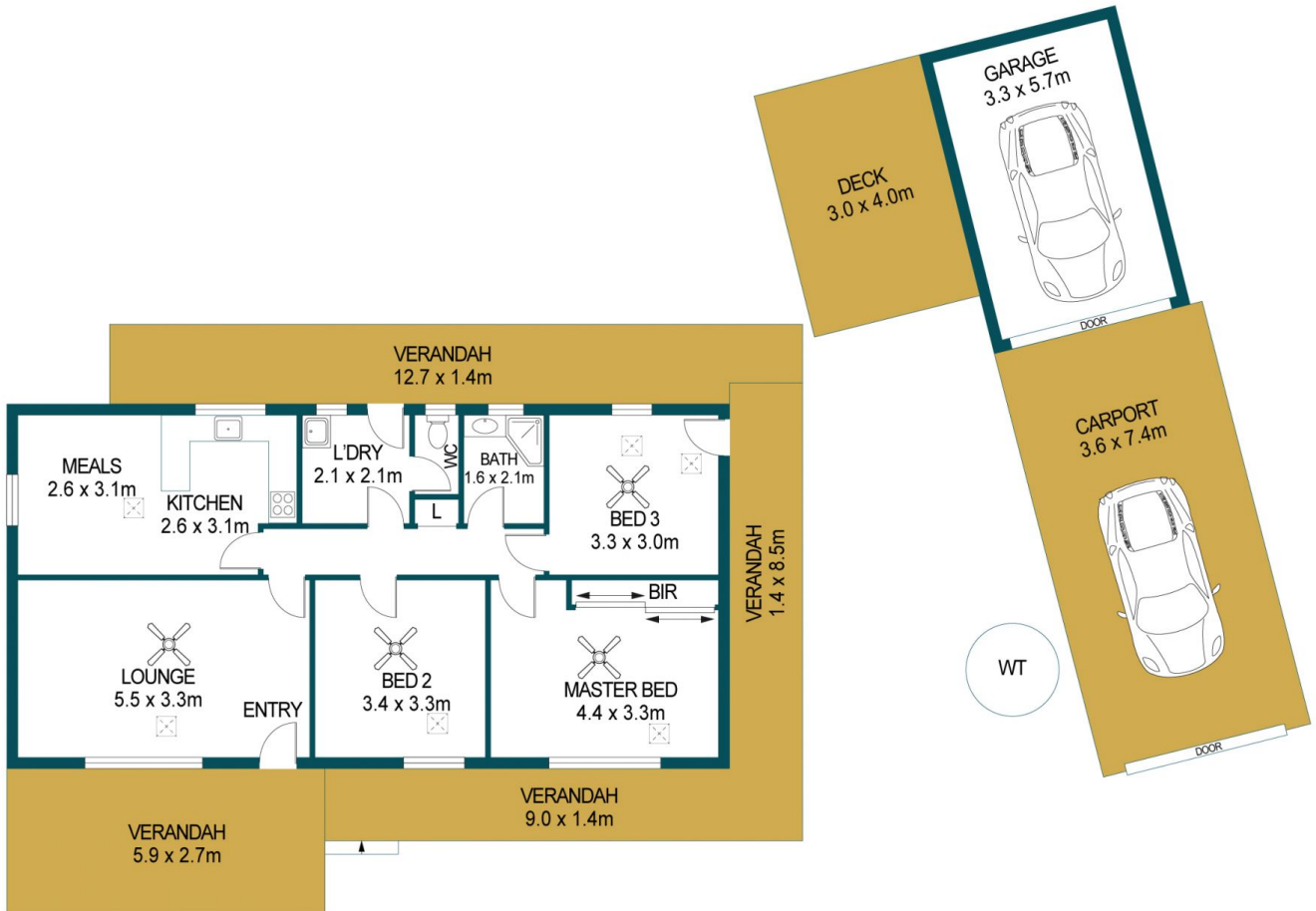

## 24 SANDFORD ROAD, DAVOREN PARK

APPROXIMATE DIMENSIONS	
LIVING:	96.5m <sup>2</sup>
CARPORT:	26.6m <sup>2</sup>
DECK:	12.0m <sup>2</sup>
VERANDAH:	53.7m <sup>2</sup>
TOTAL:	188.8m <sup>2</sup>

### DISCLAIMER

PLANS SHOWN ARE FOR MARKETING PURPOSES ONLY, ALL DIMENSIONS ARE APPROXIMATE AND NOT TO SCALE. THEY ARE SUBJECT TO ERRORS AND INACCURACIES AND NO LIABILITY WILL BE ACCEPTED. INTERESTED PARTIES SHOULD MAKE THEIR OWN ENQUIRIES.



IMAGES AND FLOORPLAN BY:  
**IN-HOUSE**  
IMAGING  
inhouseimaging.com.au