



## 49-51 Worthington Road ELIZABETH EAST SA

6 2 1

To submit an offer, please copy and paste this link into your browser:

<https://airtable.com/shrBb12PXtTjyZAXm>

Mike Lao and Edge Realty RLA256385 are proud to present to the market two homes on separate titles offering unlimited potential. With a total land size of approx 1,114 sqm and a central location within walking distance of shops and schools, this block is prime for development.

Please note that photos of 51 Worthington were taken 2021 are being reused.

Both homes have three bedrooms, one bathroom, one lounge room, an open plan kitchen and meals area plus internal laundry.

**Price** : \$ 540,000  
**Building Size** : 136 sqm  
**Land Size** : 1114 sqm  
**View** : <https://www.edgerealty.com.au/sale/sa/north-north-east-suburbs/elizabeth-east/residential/house/6960486>



**Mike Lao**  
0410390250



**Tyson Bennett**  
0437161997

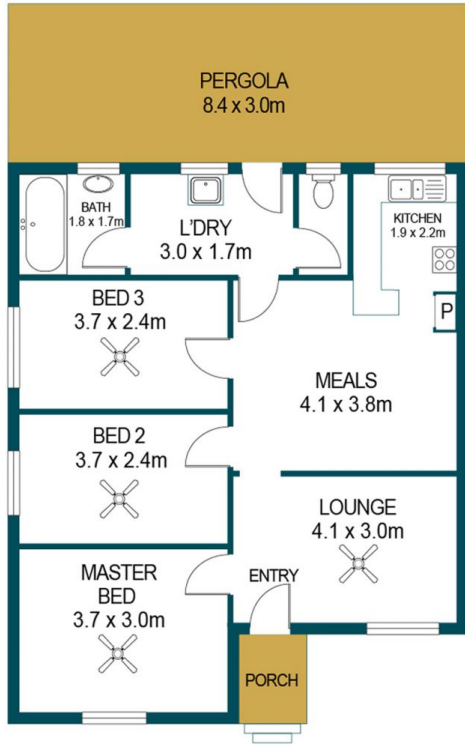

LIVING: 68.0m<sup>2</sup>  
 PERGOLA: 25.2m<sup>2</sup>  
 PORCH: 2.3m<sup>2</sup>  
 SHED: 5.3m<sup>2</sup>  
 TOTAL: 100.8m<sup>2</sup>

49 WORTHINGTON ROAD, ELIZABETH EAST

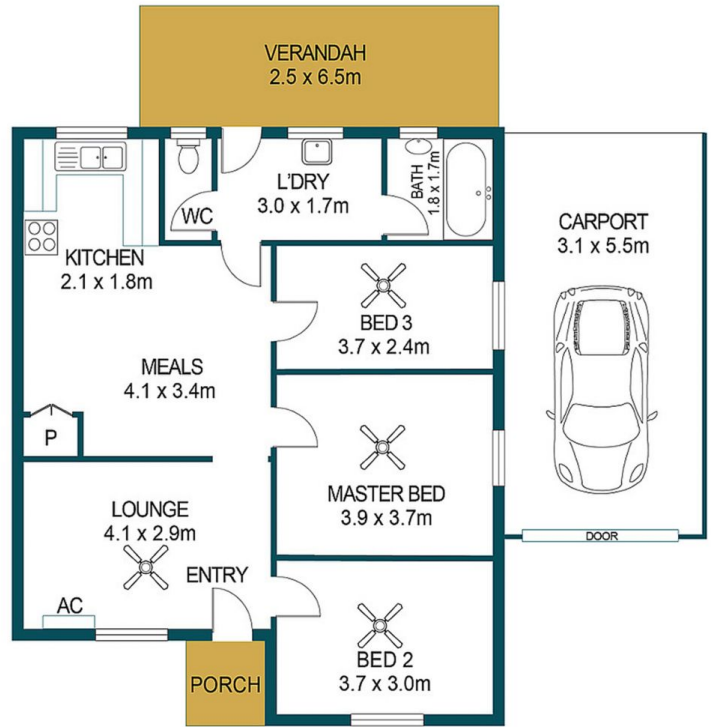

LIVING: 83.2m<sup>2</sup>  
 CARPORT: 17.1m<sup>2</sup>  
 PORCH: 2.1m<sup>2</sup>  
 VERANDAH: 13.9m<sup>2</sup>  
 TOTAL: 116.3m<sup>2</sup>

51 WORTHINGTON ROAD, ELIZABETH EAST

DISCLAIMER  
 PLANS SHOWS ARE FOR MARKETING PURPOSES ONLY. ALL DIMENSIONS ARE APPROXIMATE AND NOT TO SCALE. THEY ARE SUBJECT TO ERRORS AND INACCURACIES AND NO LIABILITY WILL BE ACCEPTED. INTERESTED PARTIES SHOULD MAKE THEIR OWN ENQUIRIES.