



2 Southan Street SMITHFIELD PLAINS SA

3 1 3

For an in-depth look at this home, please click on the 3D tour for a virtual walk-through or copy and paste this link into your browser

Virtual <https://my.matterport.com/show/?m=miCgKf3gcrs> Tour Link:

To submit an offer, please copy and paste this link into your browser:
<https://www.edgerealty.com.au/buying/make-an-offer/>

Tyson Bennett, Mike Lao and Edge Realty RLA256385 are proud to present to the market this fully renovated lovely three-bedroom, one-bathroom Smithfield Plains home. Whether you are looking for your first home, a downsizer or a savvy investment opportunity, this is a residence that is sure to tick all your boxes. With comfortable living, lush gardens, and an enviable corner block next to Smith Creek,

Price : \$ 375,000
Building Size : 196 sqm
Land Size : 592 sqm
View : <https://www.edgerealty.com.au/sale/sa/north-north-east-suburbs/smithfield-plains/residential/house/7168056>



Tyson Bennett
0437161997



Mike Lao
0410390250

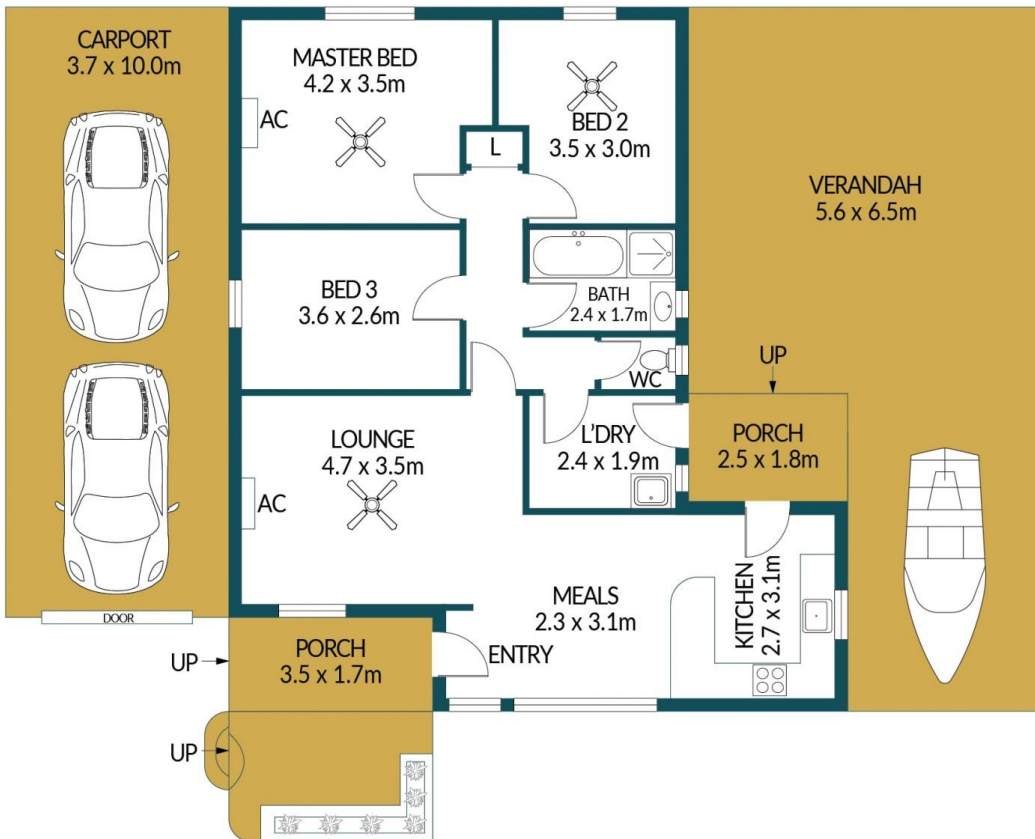
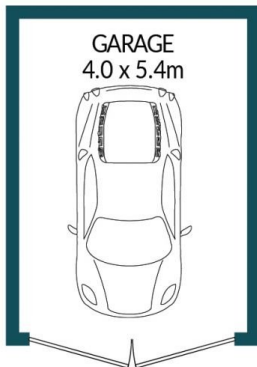

2 SOUTHAN STREET, SMITHFIELD PLAINS

Disclaimer

Plans shown are for marketing purposes only. All dimensions are approximate and not to scale. They are subject to errors and inaccuracies and no liability will be accepted. Interested parties should make their own enquiries. Inclusions and exclusions must be confirmed in the Residential Contract.

APPROXIMATE DIMENSIONS

LIVING:	91.2m ²
PORCH/GARAGE:	31.5m ²
CARPORT:	37.0m ²
VERANDAH:	36.4m ²
TOTAL:	196.1m ²