



## 1 Ifould Road ELIZABETH PARK SA

4 1 3

Captivating Family Home with Enviably Outdoor Entertaining Areas!

\*For an in-depth look at this home, please click on the 3D tour for a virtual walk-through\*

Virtual Tour Link:  
<https://my.matterport.com/show/?m=Mc67sMVjxt>

To submit an offer, please copy and paste this link into your browser:

<https://www.edgerealty.com.au/buying/make-an-offer/>

Mike Lao, Brendon Ly and Edge Realty RLA256385 are proud to present to the market this two-level family home that brims with natural light and unquestionable personality. Discover the life of comfort you deserve and be treated to four sizeable bedrooms, an inviting living space with high

**Price** : \$ 498,000  
**Building Size** : 149 sqm  
**Land Size** : 870 sqm  
**View** : <https://www.edgerealty.com.au/sale/sa/north-north-east-suburbs/elizabeth-park/residential/house/7201011>



**Mike Lao**  
0410390250



**Brendon Ly**  
0447888444

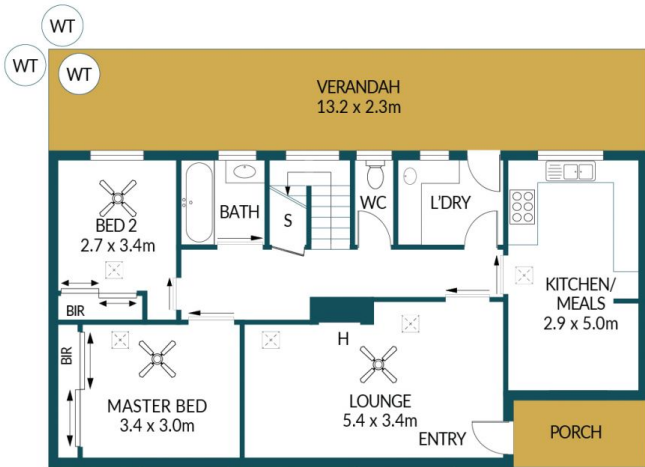
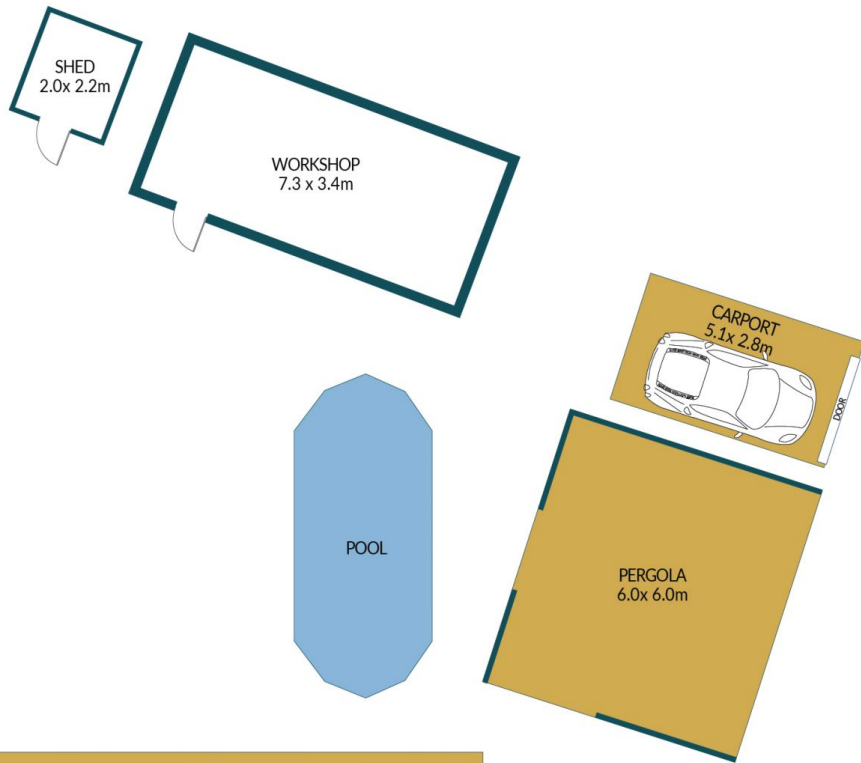

LOWER LEVEL

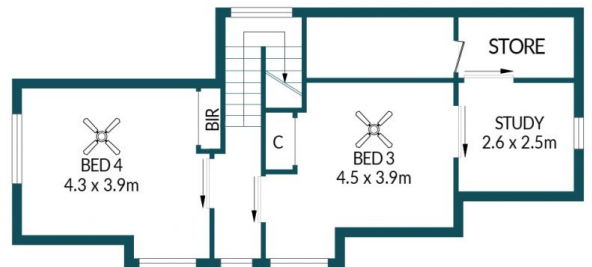

UPPER LEVEL

# 1 IFOULD ROAD, ELIZABETH PARK

## Disclaimer

Plans shown are for marketing purposes only. All dimensions are approximate and not to scale. They are subject to errors and inaccuracies and no liability will be accepted. Interested parties should make their own enquiries. Inclusions and exclusions must be confirmed in the Residential Contract.

## APPROXIMATE DIMENSIONS

LIVING:	133.2m <sup>2</sup>
GARAGE/WORKSHOP:	24.8m <sup>2</sup>
PERGOLA/SHED/PORCH:	44.6m <sup>2</sup>
CARPORT/VERANDAH:	44.7m <sup>2</sup>
TOTAL:	247.3m <sup>2</sup>