



## 34 Mosterton Road ELIZABETH PARK SA

3 1 2

\*For an in-depth look at this home, please click on the 3D tour for a virtual walk-through or copy and paste this link into your browser\*

Virtual Tour Link:  
<https://vtc.virtualtourscreator.com.au/share/45ebc6f15c1f59b39b4ebfb2222a3801>

To submit an offer, please copy and paste this link into your browser:

<https://www.edgerealty.com.au/buying/make-an-offer/>

Mike Lao, Tyson Bennett and Edge Realty RLA256385 in conjunction with McGrath Real Estate, are proud to present to the market this easy-care home that will delight first-time buyers, young families and eagle-eyed investors alike. The quaint red brick facade and convenient location add immediate appeal to this delightful home while inside, you'll

**Price** : \$ 350,000  
**Building Size** : 97 sqm  
**Land Size** : 610 sqm  
**View** : <https://www.edgerealty.com.au/sale/sa/north-north-east-suburbs/elizabeth-park/residential/house/7210189>



**Mike Lao**  
0410390250



**Tyson Bennett**  
0437161997

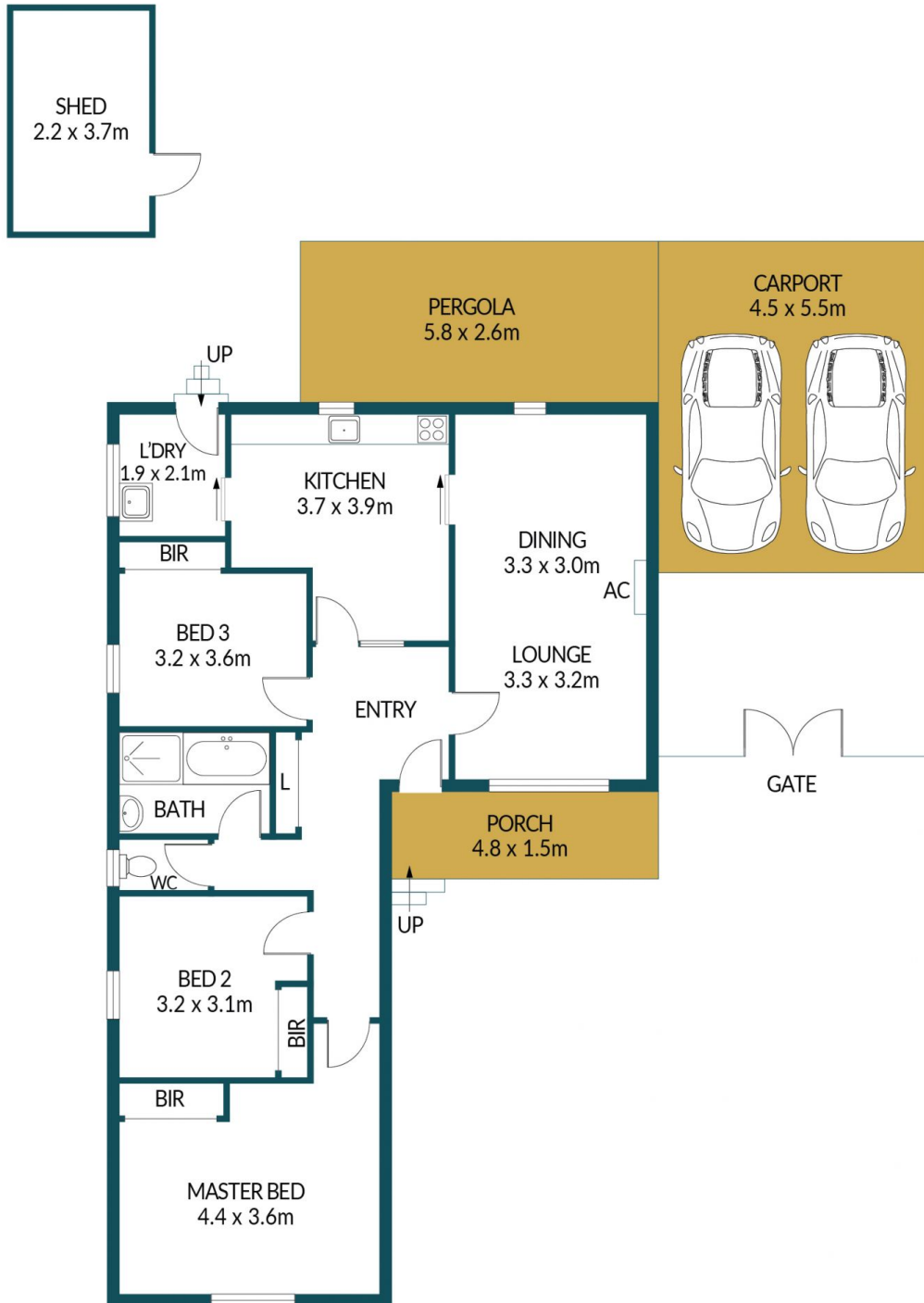

## 34 MOSTERTON ROAD, ELIZABETH PARK

### Disclaimer

Plans shown are for marketing purposes only. All dimensions are approximate and not to scale. They are subject to errors and inaccuracies and no liability will be accepted. Interested parties should make their own enquiries. Inclusions and exclusions must be confirmed in the Residential Contract.

### APPROXIMATE DIMENSIONS

LIVING:	97.9m <sup>2</sup>
CARPORT:	24.8m <sup>2</sup>
PORCH:	7.2m <sup>2</sup>
SHED/PERGOLA:	23.2m <sup>2</sup>
TOTAL:	153.1m <sup>2</sup>