



9 Gameau Road TWO WELLS SA

4 2 8

For an in-depth look at this home, please click on the 3D tour for a virtual walk-through or copy and paste this link into your browser

Virtual Tour Link:
<https://my.matterport.com/show/?m=wSP6GWiMYe7>

To submit an offer, please copy and paste this link into your browser:
<https://www.edgerealty.com.au/buying/make-an-offer/>

Mike Lao, Tyson Bennett and Edge Realty RLA256385 are proud to present to the market this beautifully presented modern property. There are four-bedrooms and plenty of space to accommodate everyone making it an ideal choice for a growing family looking for a lovely place to call home.

There is ducted reverse cycle air-conditioning system that

Price : \$ 660,000
Building Size : 151 sqm
Land Size : 1200 sqm
View : <https://www.edgerealty.com.au/sale/sa/mid-north/two-wells/residential/house/7410101>



Mike Lao
0410390250



Tyson Bennett
0437161997

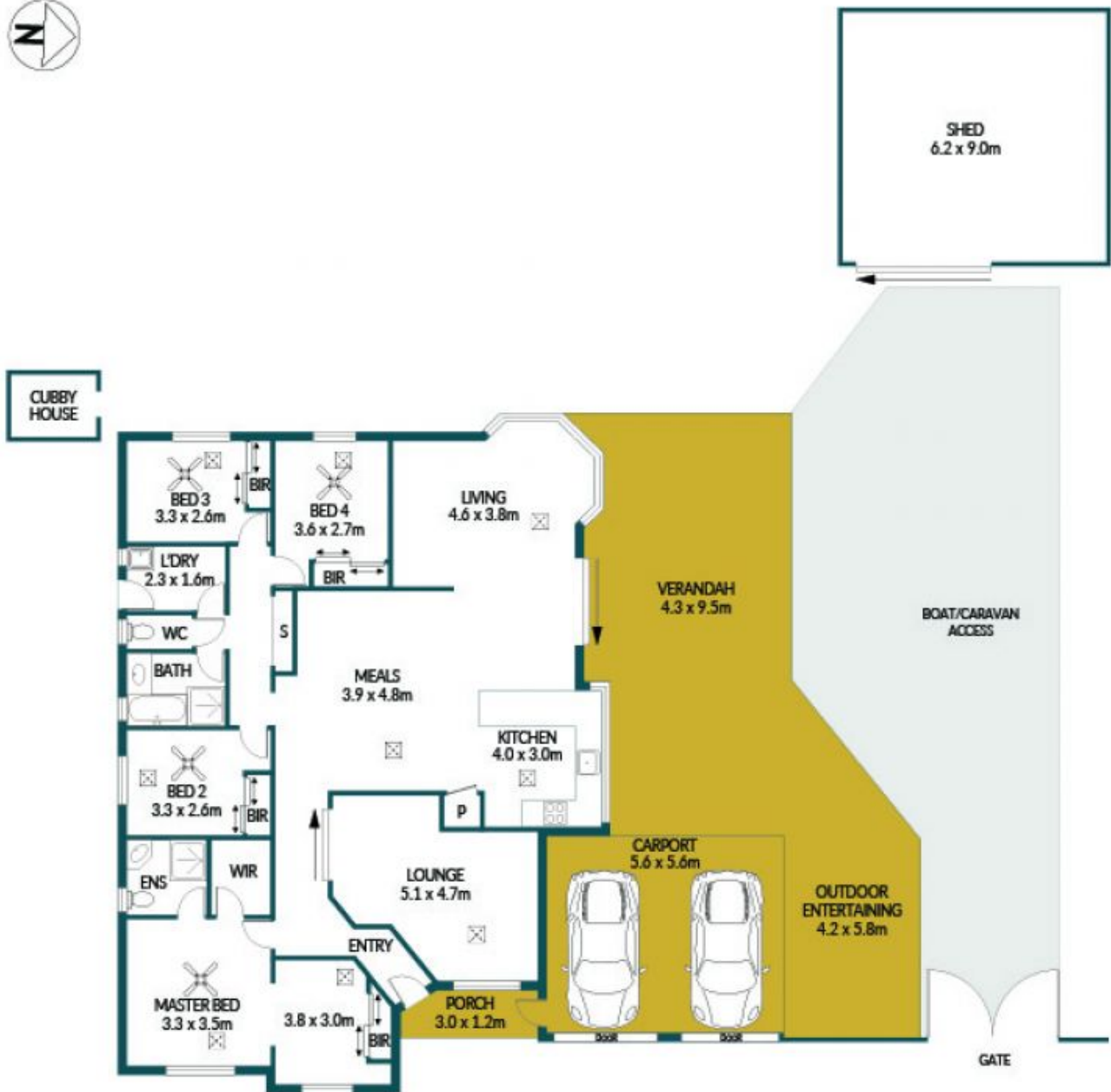

9 GAMEAU ROAD, TWO WELLS

Disclaimer

Plans shown are for marketing purposes only. All dimensions are approximate and not to scale. They are subject to errors and inaccuracies and no liability will be accepted. Interested parties should make their own enquiries. Inclusions and exclusions must be confirmed in the Residential Contract.

APPROXIMATE DIMENSIONS

| | |
|---------------|---------------------|
| LIVING: | 151.0m ² |
| CARPORT: | 31.4m ² |
| PORCH: | 3.6m ² |
| VERANDAH: | 40.9m ² |
| SHED: | 55.8m ² |
| ENTERTAINING: | 24.4m ² |
| TOTAL: | 307.1m ² |