



## 29 Weerana Road SALISBURY PLAIN SA

3 1 2

\*For an in-depth look at this home, please click on the 3D tour for a virtual walk-through or copy and paste this link into your browser\*

Virtual <https://my.matterport.com/show/?m=vFZQKAjJLy6> Tour Link:

To submit an offer, please copy and paste this link into your browser:  
<https://www.edgerealty.com.au/buying/make-an-offer/>

Mike Lao, Brendon Ly and Edge Realty RLA256385 are proud to present to the market this charming family home in Salisbury Plain that is bursting with character and potential. Whether you leave the home as-is and enjoy it for the comfort it offers, or update and modernise with your own personal touches, this property is sure to impress.

**Price** : \$ 500,000  
**Building Size** : 158 sqm  
**Land Size** : 600 sqm  
**View** : <https://www.edgerealty.com.au/sale/sa/north-north-east-suburbs/salisbury-plain/residential/house/7483598>



**Mike Lao**  
0410390250



**Brendon Ly**  
0447888444

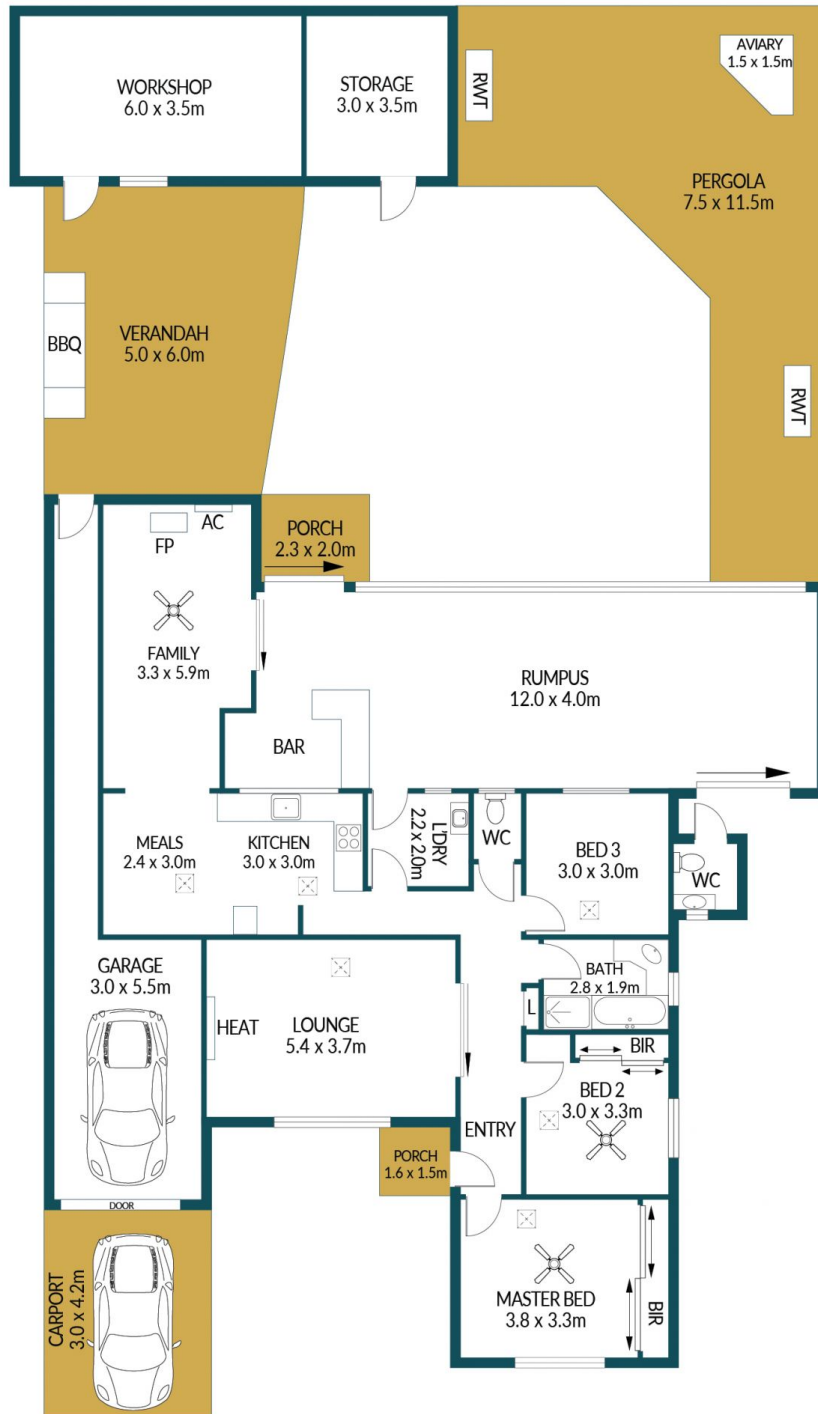

## 29 WEERANA ROAD, SALISBURY PLAIN

### Disclaimer

Plans shown are for marketing purposes only. All dimensions are approximate and not to scale. They are subject to errors and inaccuracies and no liability will be accepted. Interested parties should make their own enquiries. Inclusions and exclusions must be confirmed in the Residential Contract.

### APPROXIMATE DIMENSIONS

LIVING:	158.2m <sup>2</sup>
GARAGE/CARPORT:	38.5m <sup>2</sup>
PORCH/VERANDAH/PERGOLA:	86.9m <sup>2</sup>
AVIARY/WORKSHOP/STORAGE:	33.3m <sup>2</sup>
TOTAL:	316.9m <sup>2</sup>