



23 Tudor Crescent SMITHFIELD PLAINS SA

3 2 2

For an in-depth look at this home, please click on the 3D tour for a virtual walk-through or copy and paste this link into your browser

Virtual <https://my.matterport.com/show/?m=tpZEt9uq6QV> Tour Link:

To submit an offer, please copy and paste this link into your browser:
<https://www.edgerealty.com.au/buying/make-an-offer/>

Mike Lao, Tyson Bennett and Edge Realty RLA256385 are proud to present to the market this lovely three bedroom, two bathroom low-maintenance home with multiple living spaces to enjoy. Located in a quiet, tree-lined street in a friendly neighbourhood, this beautiful house is waiting for you to move in and make it yours!

Price : \$ 510,000
Building Size : 152 sqm
Land Size : 528 sqm
View : <https://www.edgerealty.com.au/sale/sa/north-north-east-suburbs/smithfield-plains/residential/house/7494001>



Mike Lao
0410390250



Tyson Bennett
0437161997



WT

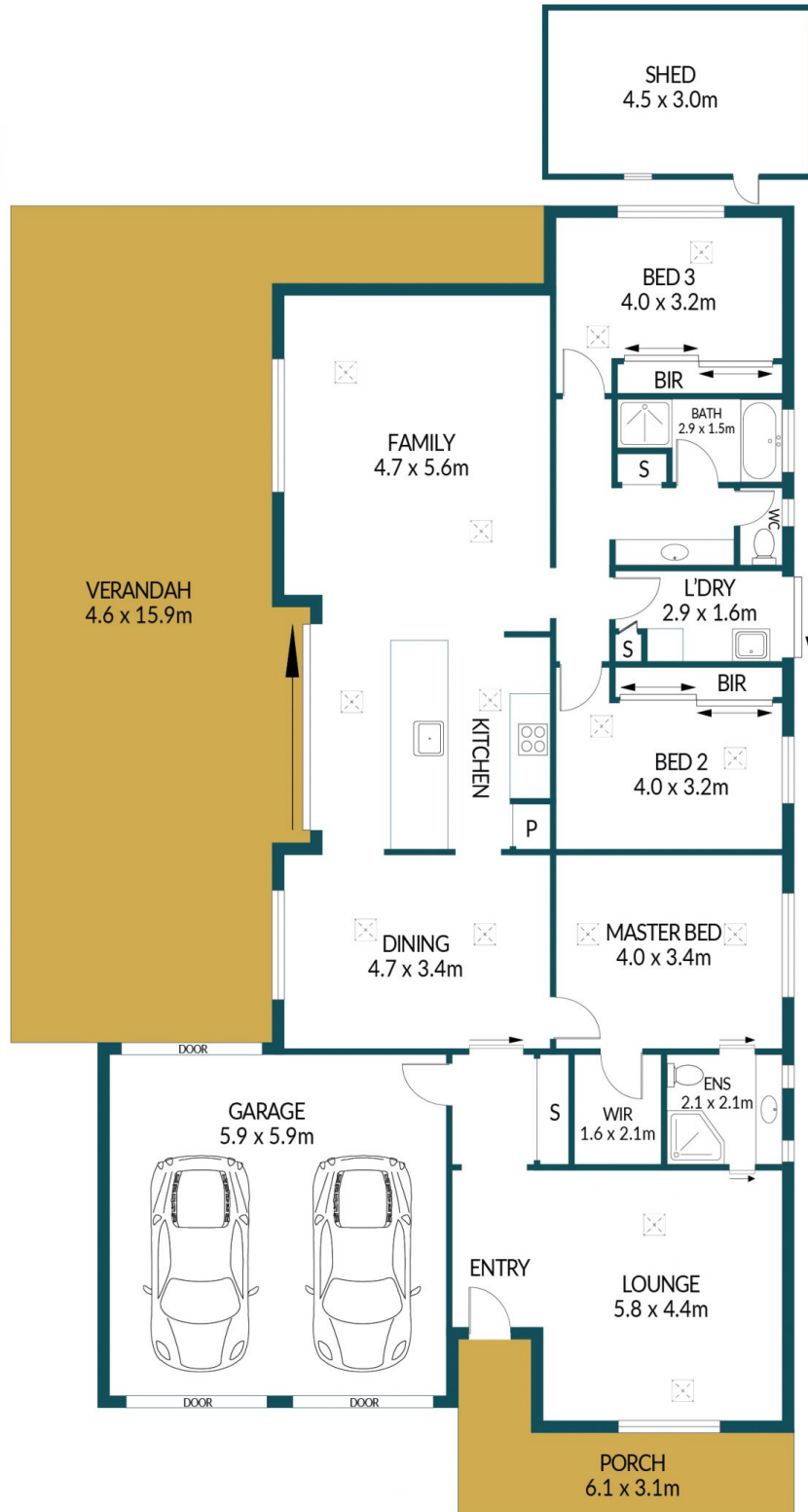

23 TUDOR CRESCENT, SMITHFIELD PLAINS

Disclaimer

Plans shown are for marketing purposes only. All dimensions are approximate and not to scale. They are subject to errors and inaccuracies and no liability will be accepted. Interested parties should make their own enquiries. Inclusions and exclusions must be confirmed in the Residential Contract.

APPROXIMATE DIMENSIONS

LIVING:	152.6m ²
GARAGE:	34.8m ²
PORCH/VERANDAH:	85.8m ²
SHED:	13.5m ²
TOTAL:	286.7m ²