



## 7 Grove Avenue ELIZABETH PARK SA

3 1 3

\*For an in-depth look at this home, please click on the 3D tour for a virtual walk-through or copy and paste this link into your browser\*

Virtual <https://my.matterport.com/show/?m=vurHxHACEKy> Tour Link:

To submit an offer, please copy and paste this link into your browser:  
<https://www.edgerealty.com.au/buying/make-an-offer/>

Mike Lao, Tyson Bennett and Edge Realty RLA256385 are proud to present to the market this stunning 3-bedroom, 1-bathroom, 1-car property located in the heart of Elizabeth Park. From the moment you arrive, you'll be captivated by its bright brick cladding, garage and side entry, and ample backyard space. This property also sits in a thoughtfully planned gated community with electric gate access for

**Price** : \$ 400,000  
**Building Size** : 89 sqm  
**Land Size** : 270 sqm  
**View** : <https://www.edgerealty.com.au/sale/sa/north-north-east-suburbs/elizabeth-park/residential/house/7557992>



**Mike Lao**  
0410390250



**Tyson Bennett**  
0437161997



SHED  
1.6 x 0.9m

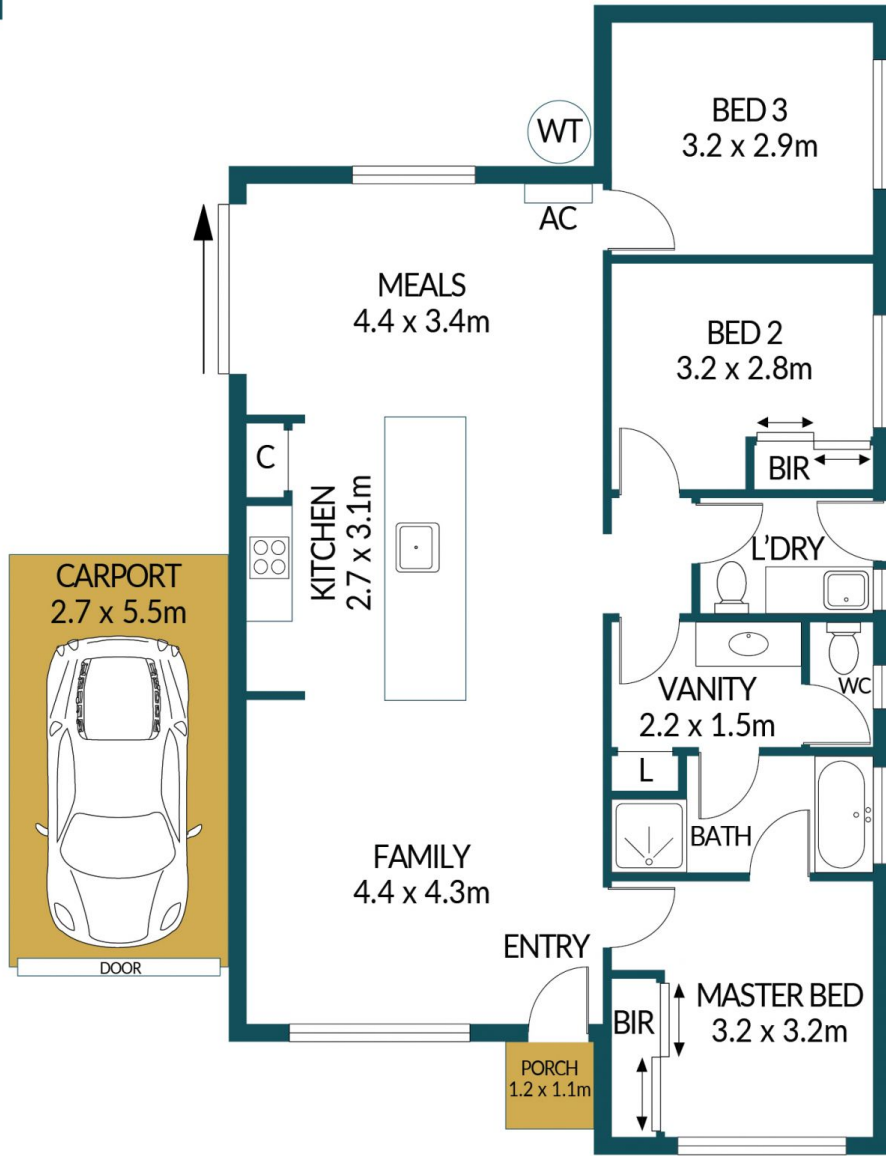

## 7 GROVE AVENUE, ELIZABETH PARK

### Disclaimer

Plans shown are for marketing purposes only. All dimensions are approximate and not to scale. They are subject to errors and inaccuracies and no liability will be accepted. Interested parties should make their own enquiries. Inclusions and exclusions must be confirmed in the Residential Contract.

### APPROXIMATE DIMENSIONS

LIVING:	89.5m <sup>2</sup>
GARAGE:	14.8m <sup>2</sup>
PORCH:	1.3m <sup>2</sup>
SHED:	1.4m <sup>2</sup>
TOTAL:	107.0m <sup>2</sup>