

615 Templers Road TEMPLERS SA

4 3 8

For an in-depth look at this home, please click on the 3D tour for a virtual walk-through or copy and paste this link into your browser

Virtual Tour Link:
<https://my.matterport.com/show/?m=ttcAw1rfGj4>

To submit an offer, please copy and paste this link into your browser:
<https://www.edgerealty.com.au/buying/make-an-offer/>

Mike Lao, Brendon Ly and Edge Realty RLA256385 are proud to present to the market your very own slice of paradise situated on 1.2hectres of prime property! Whether you have a passion for horses or you're simply dreaming of a peaceful and private property with room to move and play, this stunning Templers home could be just what you're looking for.

Price : \$ 820,000
Building Size : 190 sqm
Land Size : 1.2 ha
View : <https://www.edgerealty.com.au/sale/sa/brossa-valley/templers/residential/house/7790119>



Mike Lao
0410390250



Brendon Ly
0447888444

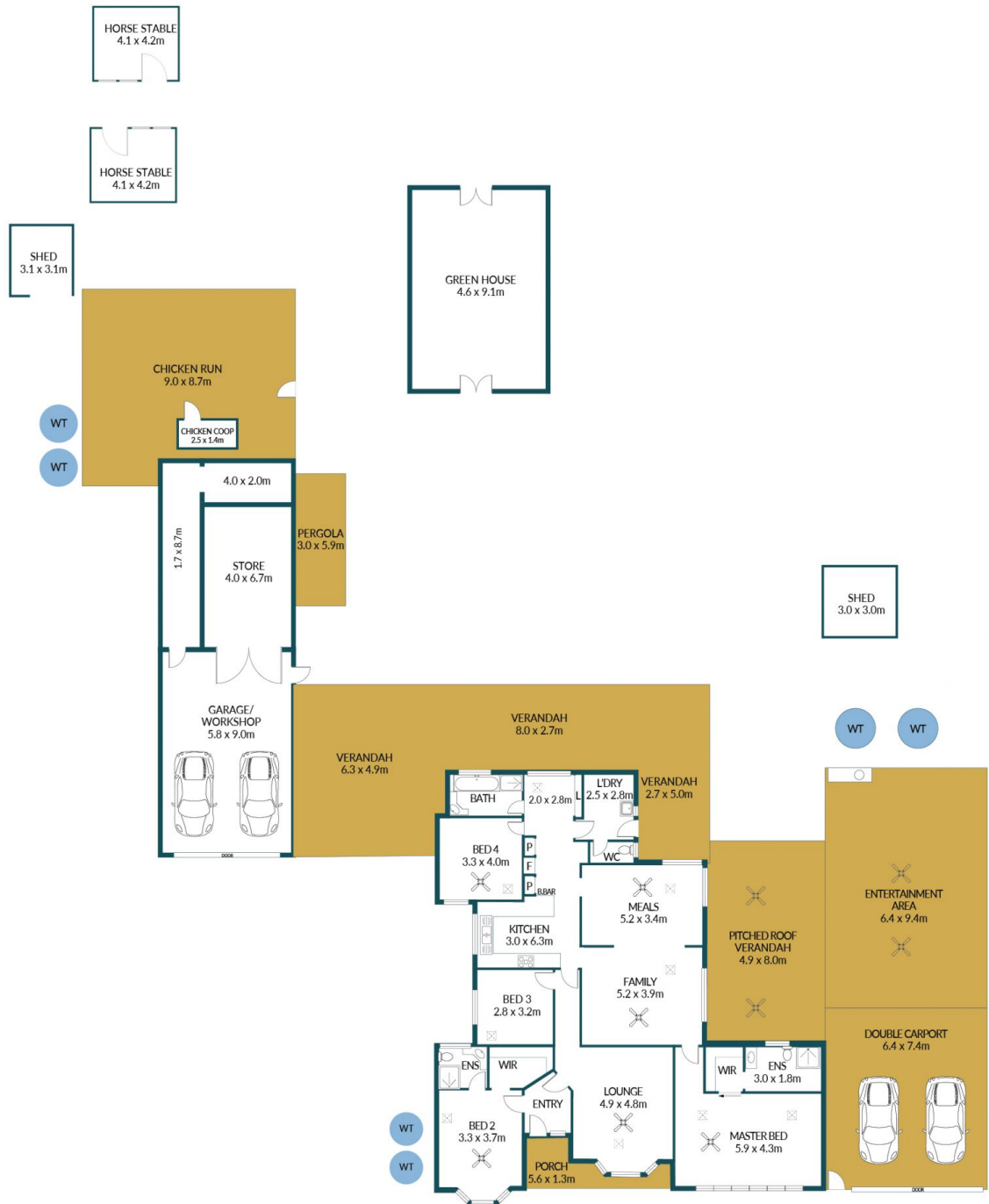

615 TEMPLERS ROAD, TEMPLERS

Disclaimer

Plans shown are for marketing purposes only. All dimensions are approximate and not to scale. They are subject to errors and inaccuracies and no liability will be accepted. Interested parties should make their own enquiries. Inclusions and exclusions must be confirmed in the Residential Contract.

APPROXIMATE DIMENSIONS

LIVING:	190.2m ²
GARAGE/CARPORT:	99.6m ²
GREEN HOUSE:	41.9m ²
HORSE STABLE:	17.2m ²
PERGOLA/VERANDAH:	122.9m ²
SHED/PORCH:	25.9m ²
ENTERTAINING:	60.2m ²
TOTAL:	557.9m ²