



15 Trembath Road ELIZABETH VALE SA

2 1 4

For an in-depth look at this home, please click on the 3D tour for a virtual walk-through or copy and paste this link into your browser

Virtual <https://my.matterport.com/models/ZnLcRZkwkew> Tour Link:

To submit an offer, please copy and paste this link into your browser:
<https://www.edgerealty.com.au/buying/make-an-offer/>

Mike Lao, Tyson Bennett and Edge Realty RLA256385 are proud to present to the market this wonderful solid brick beauty well loved by its current owners and ready to be transformed into something truly incredible with your loving touch. This well-situated two-bedroom home is set on an expansive 740sqm approx block within walking distance to the local shops, Lyell McEwin Hospital, public transport

Price : \$ 483,600
Building Size : 79 sqm
Land Size : 740 sqm
View : <https://www.edgerealty.com.au/sale/sa/north-north-east-suburbs/elizabeth-vale/residential/house/7812399>



Mike Lao
0410390250



Tyson Bennett
0437161997

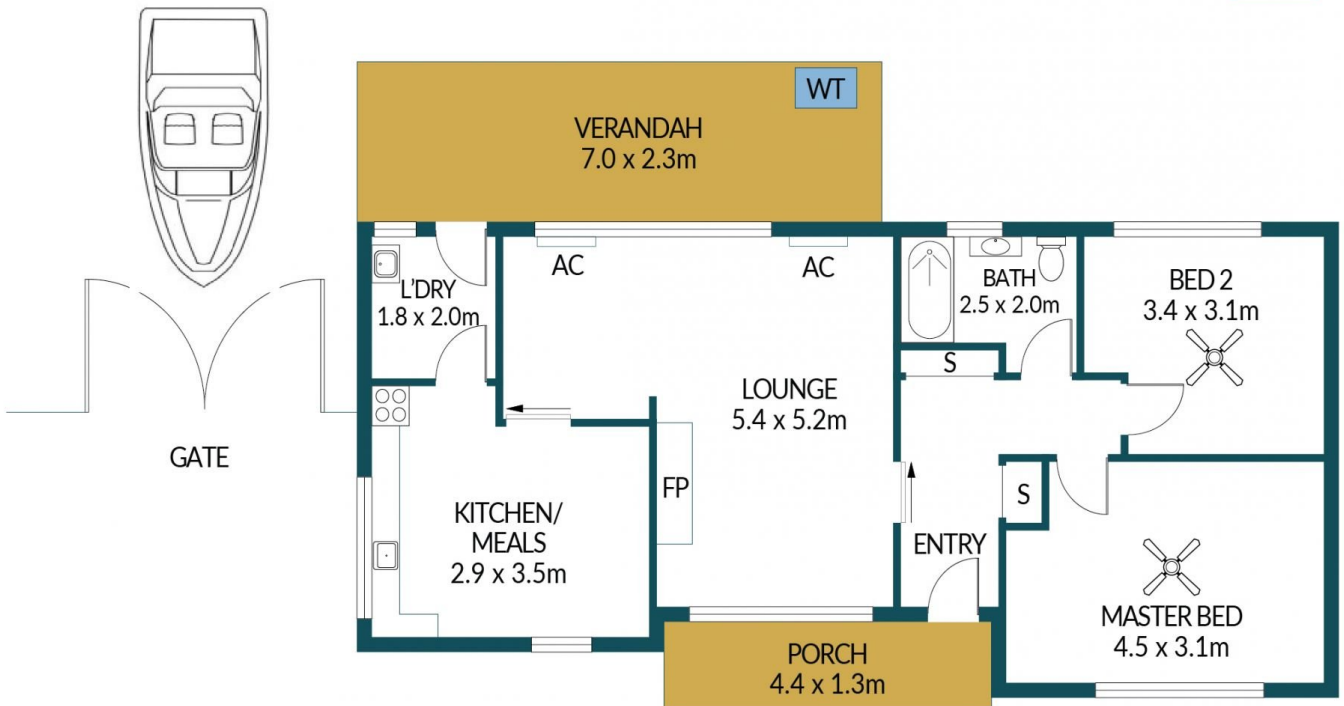
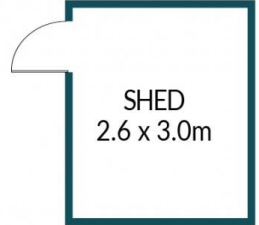

15 TREMBATH ROAD, ELIZABETH VALE

Disclaimer

Plans shown are for marketing purposes only. All dimensions are approximate and not to scale. They are subject to errors and inaccuracies and no liability will be accepted. Interested parties should make their own enquiries. Inclusions and exclusions must be confirmed in the Residential Contract.

APPROXIMATE DIMENSIONS

LIVING:	79.9m ²
GARAGE:	13.4m ²
PORCH/VERANDAH:	21.8m ²
SHED:	9.9m ²
TOTAL:	125.0m ²