



Disclaimer: All dimensions are approximate. Interested parties should make their own enquiries.



296-304 Diment Road BURTON SA

4 1 4

For an in-depth look at this home, please click on the 3D tour for a virtual walk-through or copy and paste this link into your browser

Virtual <https://my.matterport.com/show/?m=rhccoionX1m> Tour Link:

To submit an offer, please copy and paste this link into your browser:
<https://www.edgerealty.com.au/buying/make-an-offer/>

Auction: Tuesday the 23rd of April 2024 at 6:15pm onsite (Unless Sold Prior)

Mike Lao, Brendon Ly and Edge Realty RLA256385 are proud to present to market a unique opportunity to purchase a gorgeous 1.330 hectare corner block property zoned rural living, providing a perfect blend of tranquility

Price : \$ 1,610,000
Building Size : 145 sqm
Land Size : 1.33 ha
View : <https://www.edgerealty.com.au/sale/sa/north-north-east-suburbs/burton/residential/house/7930040>



Mike Lao
0410390250



Brendon Ly
0447888444

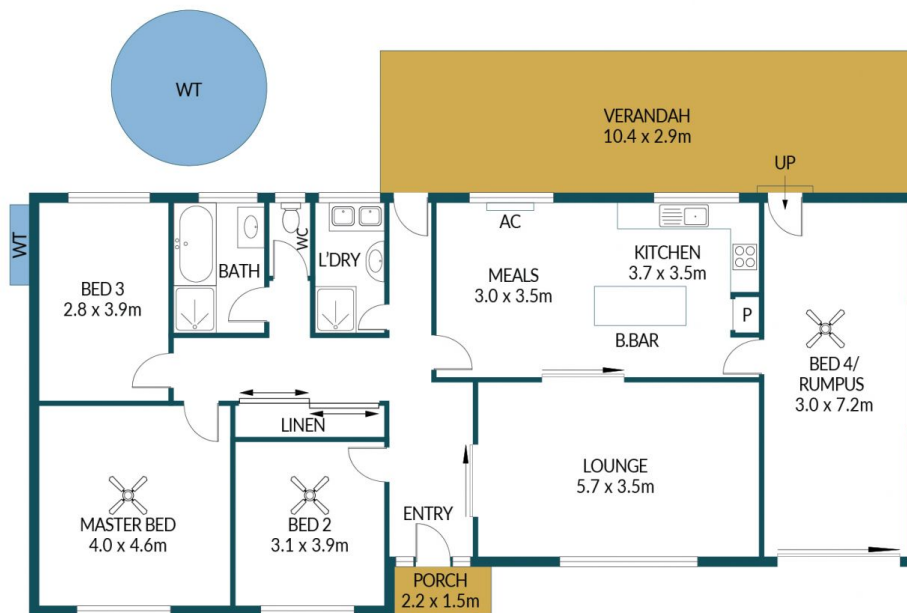
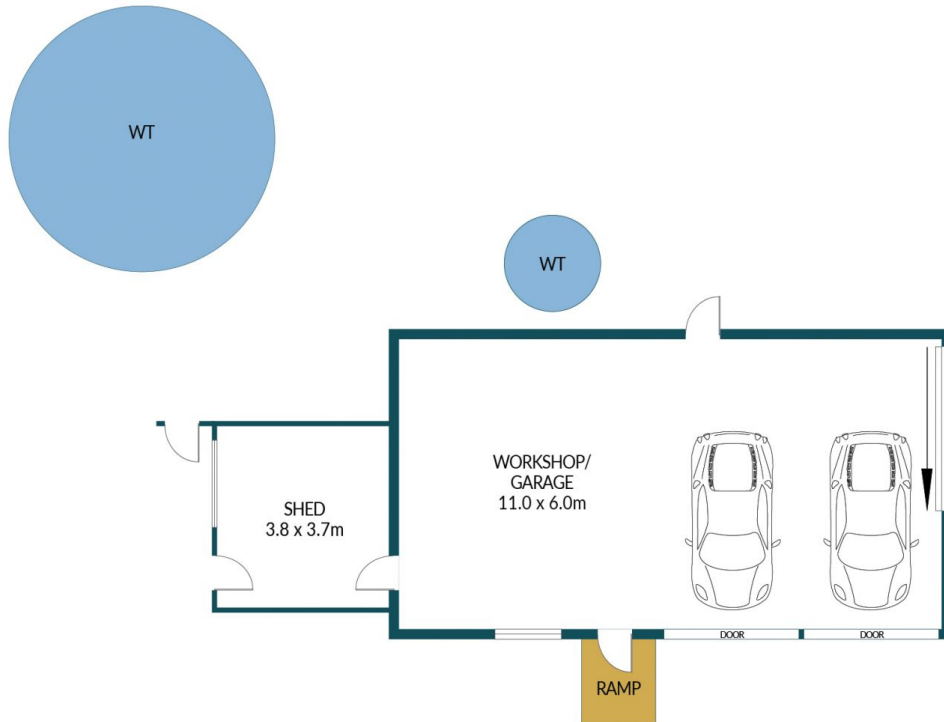

296-304 DIMENT ROAD, BURTON

Disclaimer

Plans shown are for marketing purposes only. All dimensions are approximate and not to scale. They are subject to errors and inaccuracies and no liability will be accepted. Interested parties should make their own enquiries. Inclusions and exclusions must be confirmed in the Residential Contract.

APPROXIMATE DIMENSIONS

LIVING:	145.8m ²
GARAGE/WORKSHOP:	66.0m ²
PORCH/SHED:	17.4m ²
VERANDAH:	30.2m ²
TOTAL:	259.4m ²

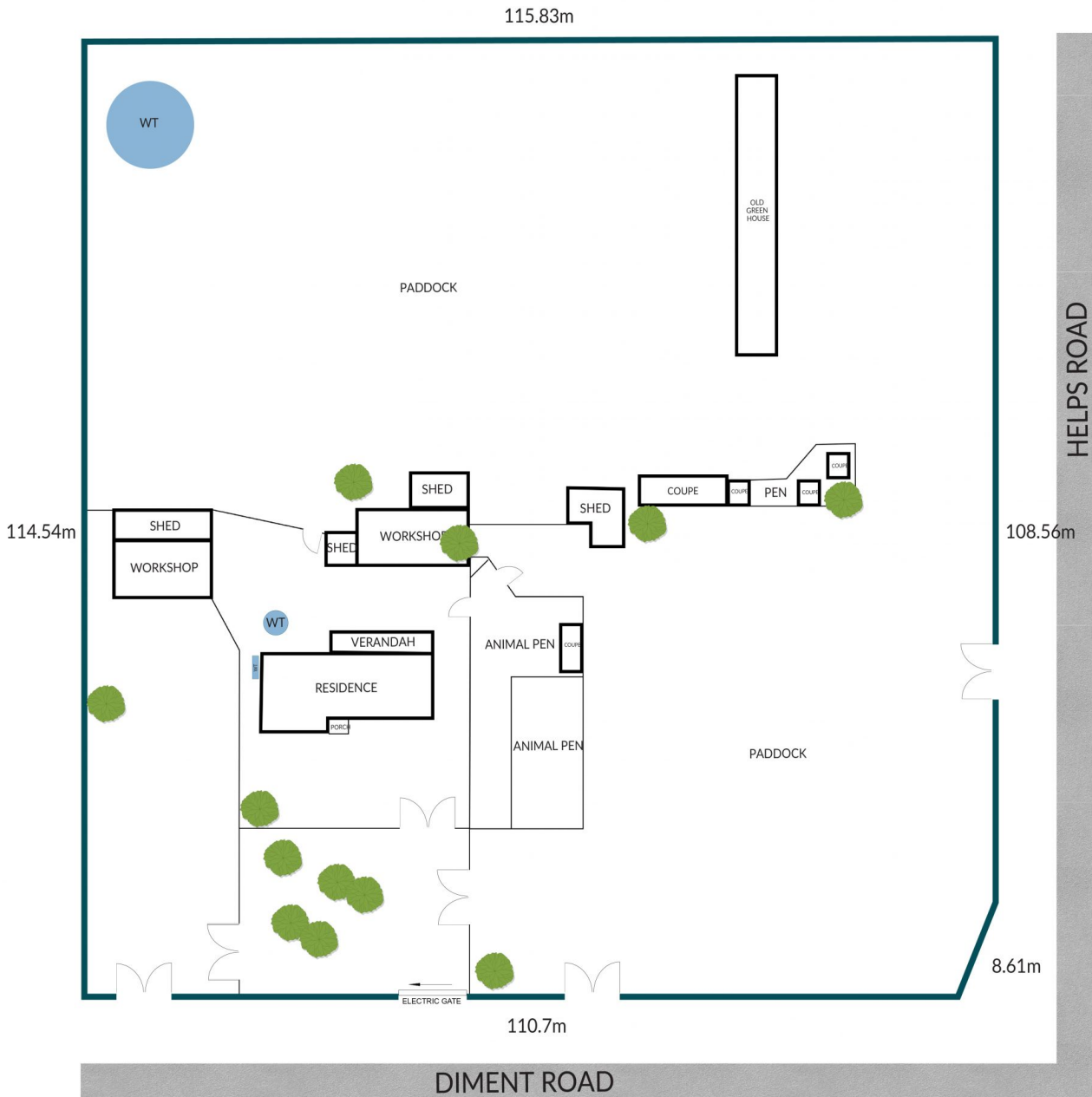

SITEPLAN - 296 - 304 DIMENT ROAD, BURTON

Disclaimer

Plans shown are for marketing purposes only. All dimensions are approximate and not to scale. They are subject to errors and inaccuracies and no liability will be accepted. Interested parties should make their own enquiries. Inclusions and exclusions must be confirmed in the Residential Contract.