



152 Goodman Road ELIZABETH SOUTH SA

3 1 1

For an in-depth look at this home, please click on the 3D tour for a virtual walk-through or copy and paste this link into your browser

Virtual <https://my.matterport.com/show/?m=tR8TDJknCRY> Tour Link:

To submit an offer, please copy and paste this link into your browser:
<https://www.edgerealty.com.au/buying/make-an-offer/>

Mike Lao, Tyson Bennett and Edge Realty RLA256385 are proud to present to the market this spacious maisonette offering the perfect blend of comfort and convenience nestled on a corner block opposite the picturesque Willison Reserve. Boasting multiple living spaces, two kitchens, and three bedrooms, this solid brick construction will delight families, first home buyers, and investors alike.

Price : \$ 470,000
Building Size : 114 sqm
Land Size : 652 sqm
View : <https://www.edgerealty.com.au/sale/sa/north-north-east-suburbs/elizabeth-south/residential/house/8013370>



Mike Lao
0410390250



Tyson Bennett
0437161997

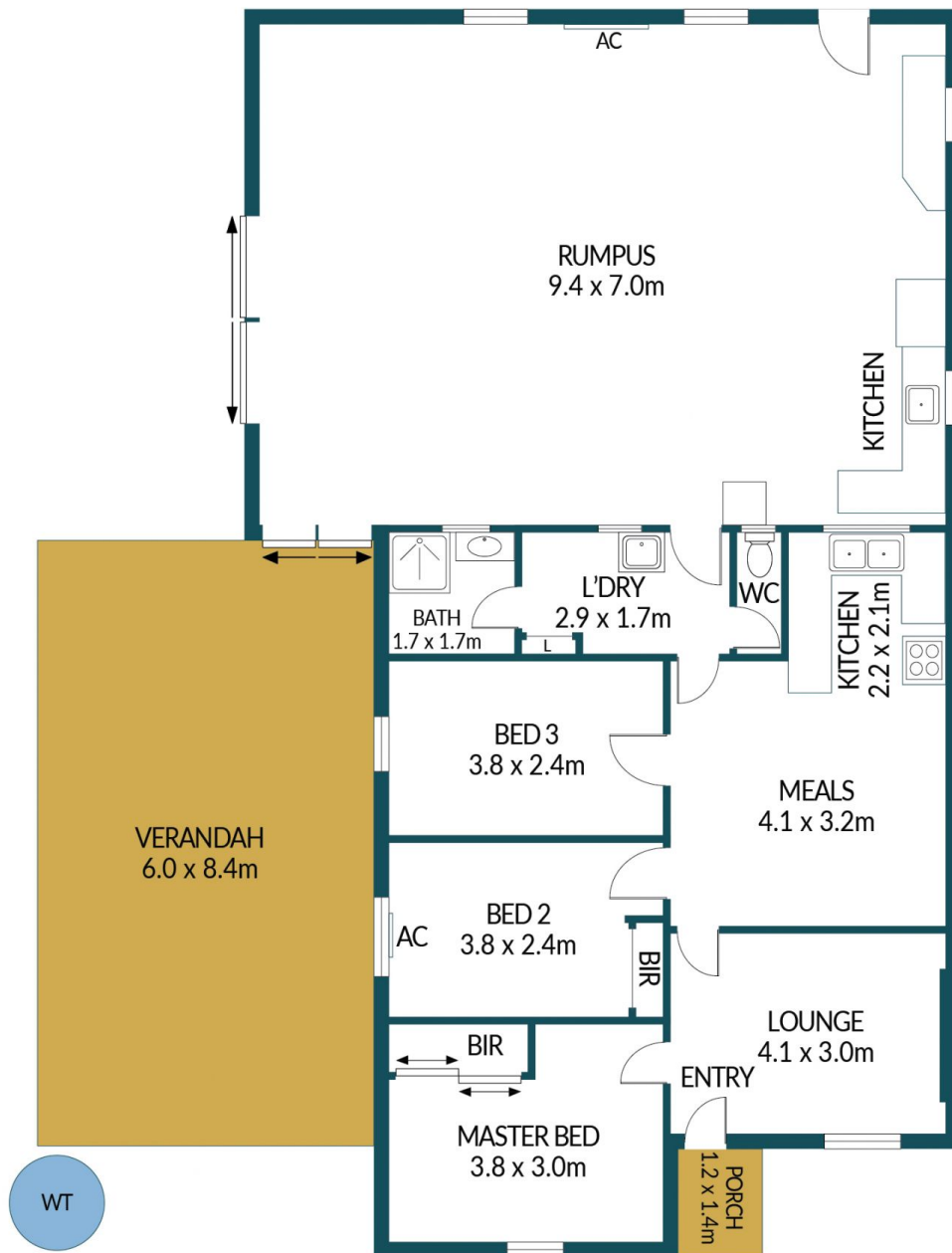
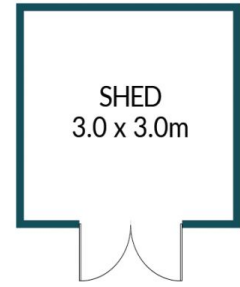

152 GOODMAN ROAD, ELIZABETH SOUTH

Disclaimer

Plans shown are for marketing purposes only. All dimensions are approximate and not to scale. They are subject to errors and inaccuracies and no liability will be accepted. Interested parties should make their own enquiries. Inclusions and exclusions must be confirmed in the Residential Contract.

APPROXIMATE DIMENSIONS

LIVING:	114.0m ²
VERANDAH:	50.4m ²
PORCH:	1.7m ²
SHED:	9.0m ²
TOTAL:	175.1m ²