

2/74 Park Terrace SALISBURY SA

For an in-depth look at this space, please click on the 3D tour for a virtual walk-through or copy and paste this link into your browser

Virtual Tour Link:
<https://my.matterport.com/show/?m=Vfzbz2zH5DE>

To submit an offer, please copy and paste this link into your browser:
<https://www.edgerealty.com.au/buying/make-an-offer/>

Mike Lao, Brendon Ly and Edge Realty RLA256385 are proud to present to the market this high-quality office space in the heart of Salisbury with a tenancy already in place paying \$2,000 per month until 30 June 2025. Take advantage of the Stamp Duty Exception when purchasing a Commercial Property.

Price : \$530,000 - \$580,000
Building Size : 88 sqm
View : <https://www.edgerealty.com.au/sale/sa/north-north-east-suburbs/salisbury/commercial/retail/8025947>



Mike Lao
0410390250



Brendon Ly
0447888444

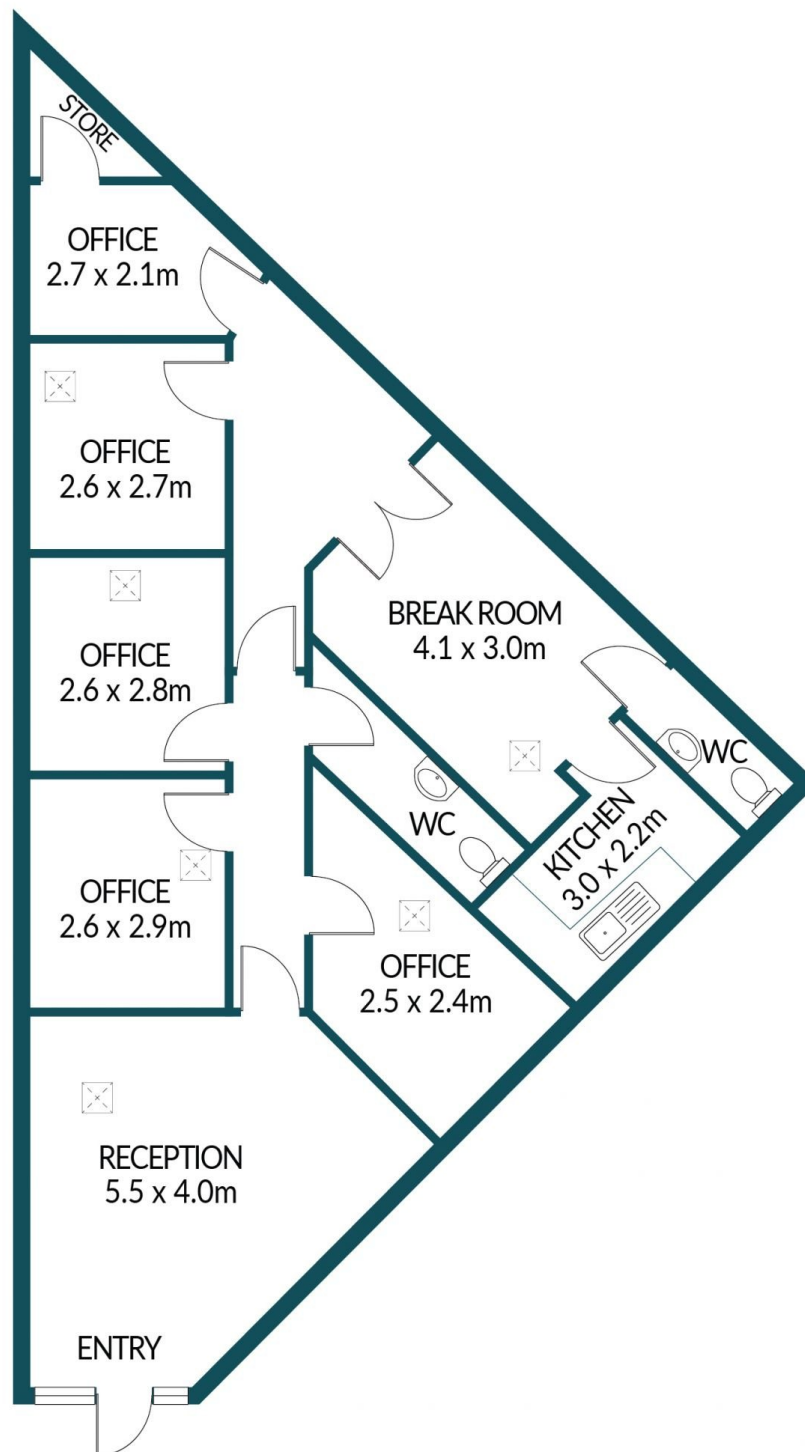

2/74 PARK TERRACE, SALISBURY

Disclaimer

Plans shown are for marketing purposes only. All dimensions are approximate and not to scale. They are subject to errors and inaccuracies and no liability will be accepted. Interested parties should make their own enquiries. Inclusions and exclusions must be confirmed in the Residential Contract.

TOTAL AREA: 88.0m²