



505 Milne Road RIDGEHAVEN SA

3 1 3

For an in-depth look at this home, please click on the 3D tour for a virtual walk-through or copy and paste this link into your browser

Virtual Tour Link: <https://shorturl.at/uUCUX>

To submit an offer, please copy and paste this link into your browser:

<https://www.edgerealty.com.au/buying/make-an-offer/>

Mike Lao, Brendon Ly and Edge Realty RLA256385 are proud to present to the market this fantastic opportunity for families, first home buyers and investors alike! This beautiful Ridgehaven property boasts multiple light-filled living areas, perfect for creating a haven for the whole family. Stay comfortable year-round with ducted air-conditioning throughout, ensuring a cool escape in summer.

Building Size : 99 sqm
Land Size : 620 sqm
View : <https://www.edgerealty.com.au/sale/sa/north-north-east-suburbs/ridgehaven/residential/house/8045080>



Mike Lao
0410390250



Brendon Ly
0447888444

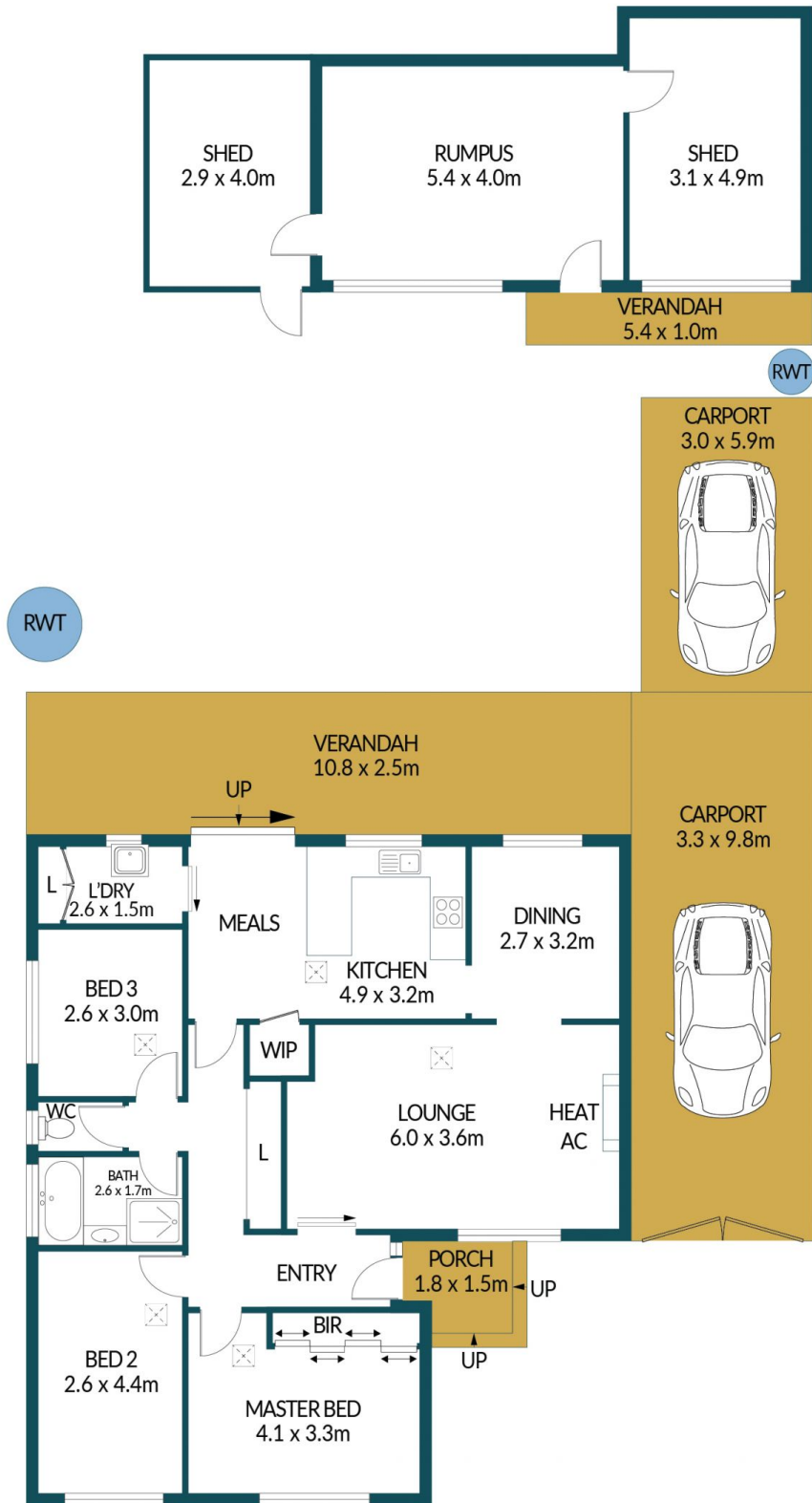

505 MILNE ROAD, RIDGEHAVEN

Disclaimer

Plans shown are for marketing purposes only. All dimensions are approximate and not to scale. They are subject to errors and inaccuracies and no liability will be accepted. Interested parties should make their own enquiries. Inclusions and exclusions must be confirmed in the Residential Contract.

APPROXIMATE DIMENSIONS

LIVING:	99.3m ²
PORCH/SHED:	29.9m ²
CARPORT/RUMPUS:	71.7m ²
VERANDAH:	32.4m ²
TOTAL:	233.3m ²