



17A Kilmington Road DAVOREN PARK SA

4 2 2

For an in-depth look at this home, please click on the 3D tour for a virtual walk-through or copy and paste this link into your browser

Virtual Tour Link:
<https://my.matterport.com/show/?m=Vm49Bh93qvP>

To submit an offer, please copy and paste this link into your browser:
<https://www.edgerealty.com.au/buying/make-an-offer/>

Mike Lao, Tyson Bennett and Edge Realty RLA256385 are proud to present to the market this brand new modern marvel boasting a contemporary design with a neutral colour scheme, creating a blank canvas for you to personalise your dream home. Featuring high ceilings that add a sense of spaciousness, an open floor plan for a seamless flow, and Rinnai ZoneTouch3 for ultimate climate

Price : Best offer by 9am Tues 6th of August (USP)

Building Size : 178 sqm

Land Size : 457 sqm

View : <https://www.edgerealty.com.au/sale/sa/north-north-east-suburbs/davoren-park/residential/house/8077950>



Mike Lao
 0410300350



Tyson Bennett
 0497461997

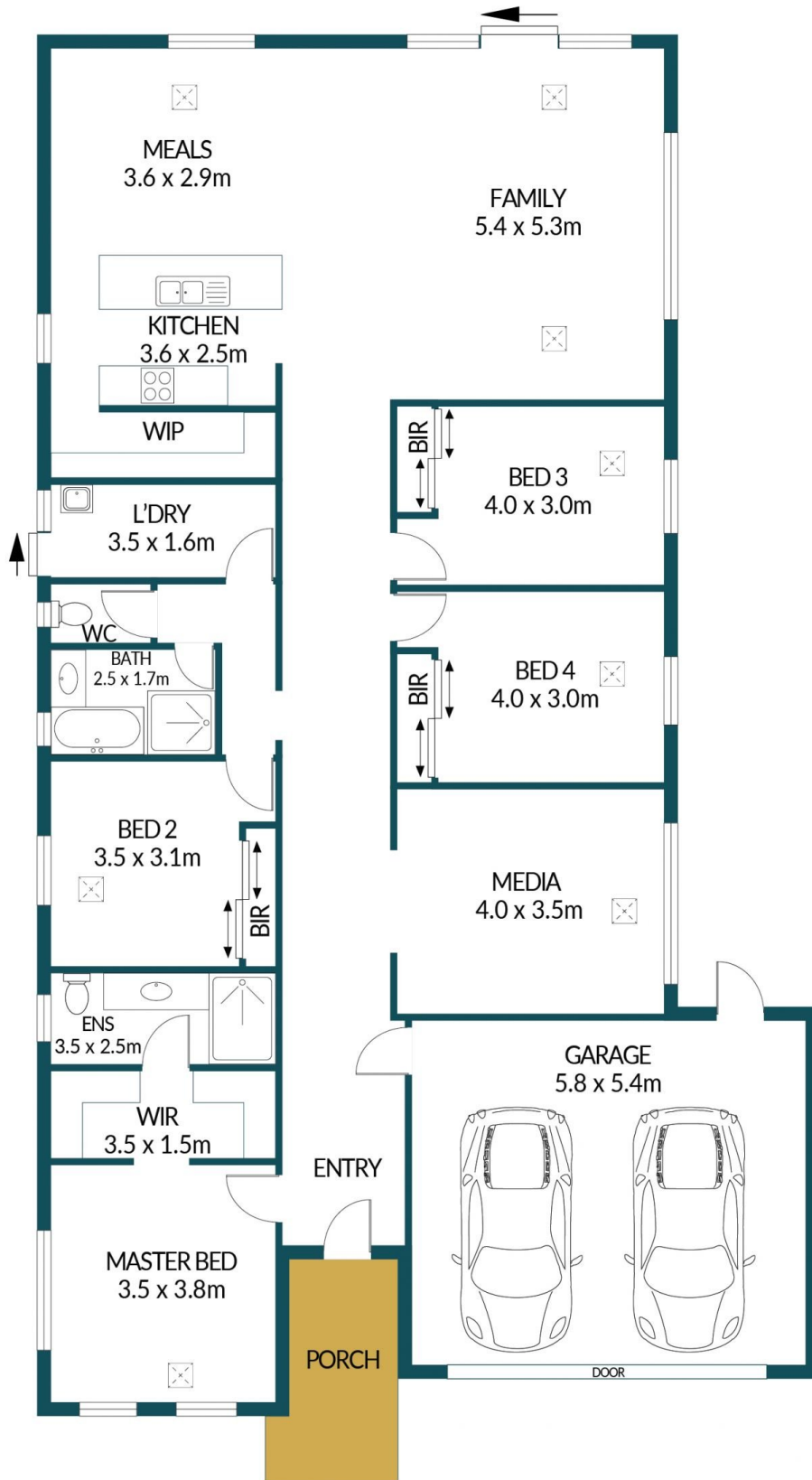

17A KILMINGTON ROAD, DAVOREN PARK

Disclaimer

Plans shown are for marketing purposes only. All dimensions and placements are approximate and not to scale. They are subject to errors and inaccuracies and no liability will be accepted. Interested parties should make their own enquiries. Inclusions and exclusions must be confirmed in the Residential Contract.

APPROXIMATE DIMENSIONS

LIVING:	178.8m ²
GARAGE:	35.7m ²
PORCH:	4.9m ²
TOTAL:	219.5m ²