



16 Kentish Road ELIZABETH DOWNS SA

3 1 1

For an in-depth look at this home, please click on the 3D tour for a virtual walk-through or copy and paste this link into your browser

Virtual Tour Link: <https://shorturl.at/KL42Z>

To submit an offer, please copy and paste this link into your browser:

<https://www.edgerealty.com.au/buying/make-an-offer/>

Mike Lao, Brendon Ly and Edge Realty RLA256385 are proud to present to the market a humble abode set on an 830sqm approx block, perfect for families, first-home buyers, astute investors and developers alike. This charming property offers the perfect canvas to create a lifetime of memories and is ready for you to make it your

[For full version visit the website](https://www.edgerealty.com.au)

Type : House
Price : \$ 570,000
Building Size : 69 sqm
Land Size : 830 sqm
View : <https://www.edgerealty.com.au/sale/sa/north-north-east-suburbs/elizabeth-downs/residential/house/8083667>



Mike Lao
0419399359



Brendon Ly
0417888444

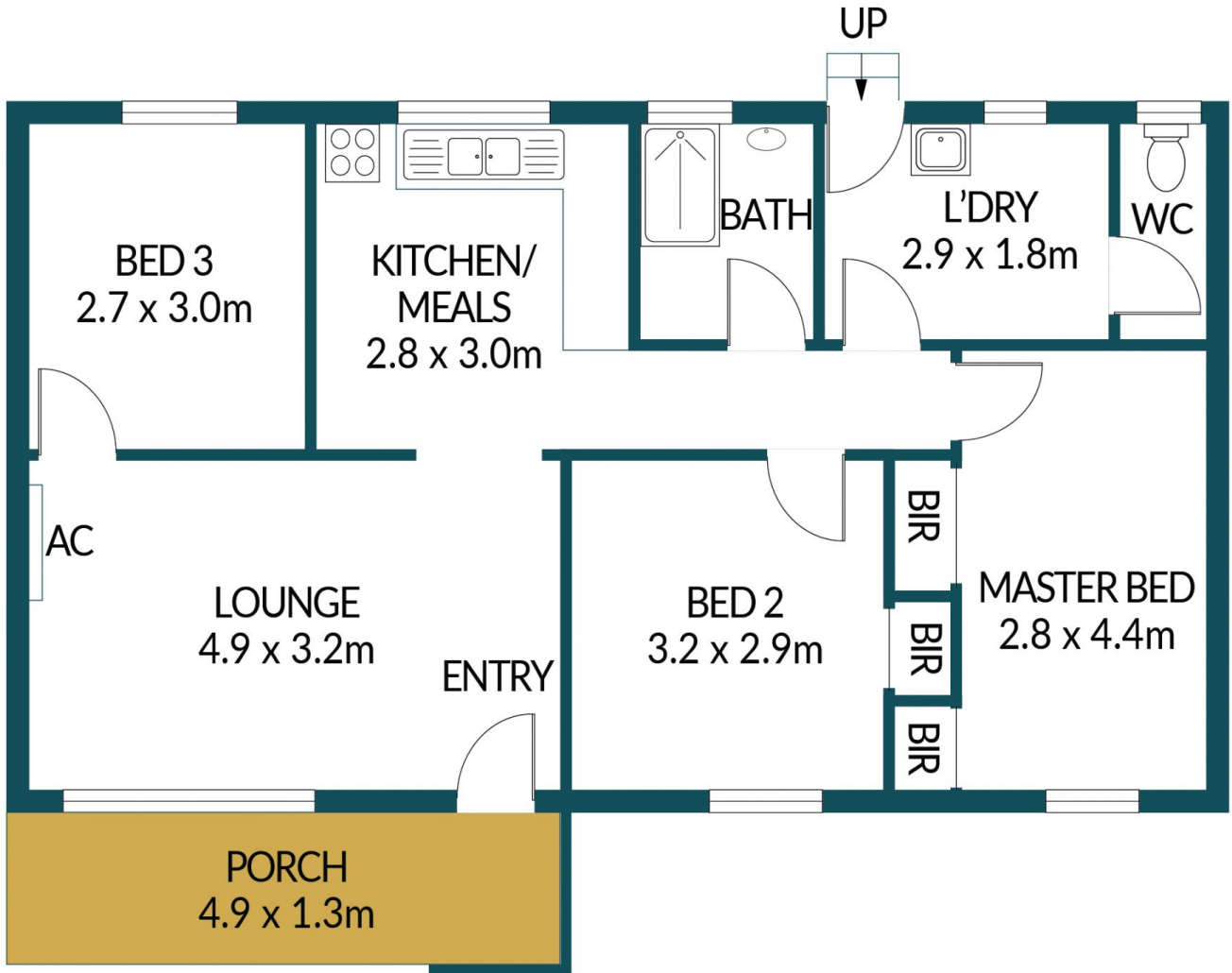

16 KENTISH ROAD, ELIZABETH DOWNS

Disclaimer

Plans shown are for marketing purposes only. All dimensions and placements are approximate and not to scale. They are subject to errors and inaccuracies and no liability will be accepted. Interested parties should make their own enquiries. Inclusions and exclusions must be confirmed in the Residential Contract.

APPROXIMATE DIMENSIONS

LIVING:	69.8m ²
PORCH:	6.4m ²
TOTAL:	76.2m ²