



10 Prunus Avenue ELIZABETH VALE SA

3 1 2

For an in-depth look at this home, please click on the 3D tour for a virtual walk-through or copy and paste this link into your browser

Virtual <https://my.matterport.com/show/?m=RLAokihKCat> Tour Link:

To submit an offer, please copy and paste this link into your browser:
<https://www.edgerealty.com.au/buying/make-an-offer/>

Mike Lao, Brendon Ly and Edge Realty RLA256385 are proud to present to the market 10 Prunus Avenue, Elizabeth Vale, a well-situated three-bedroom home that offers those who live here a life of comfort, ease and convenience. Are you a first home buyer looking for the

[For full version visit the website](https://www.edgerealty.com.au)

Type : House
Building Size : 92 sqm
Land Size : 770 sqm
View : <https://www.edgerealty.com.au/sale/sa/north-north-east-suburbs/elizabeth-vale/residential/house/8133938>



Mike Lao
0410390250



Brendon Ly
0447888444

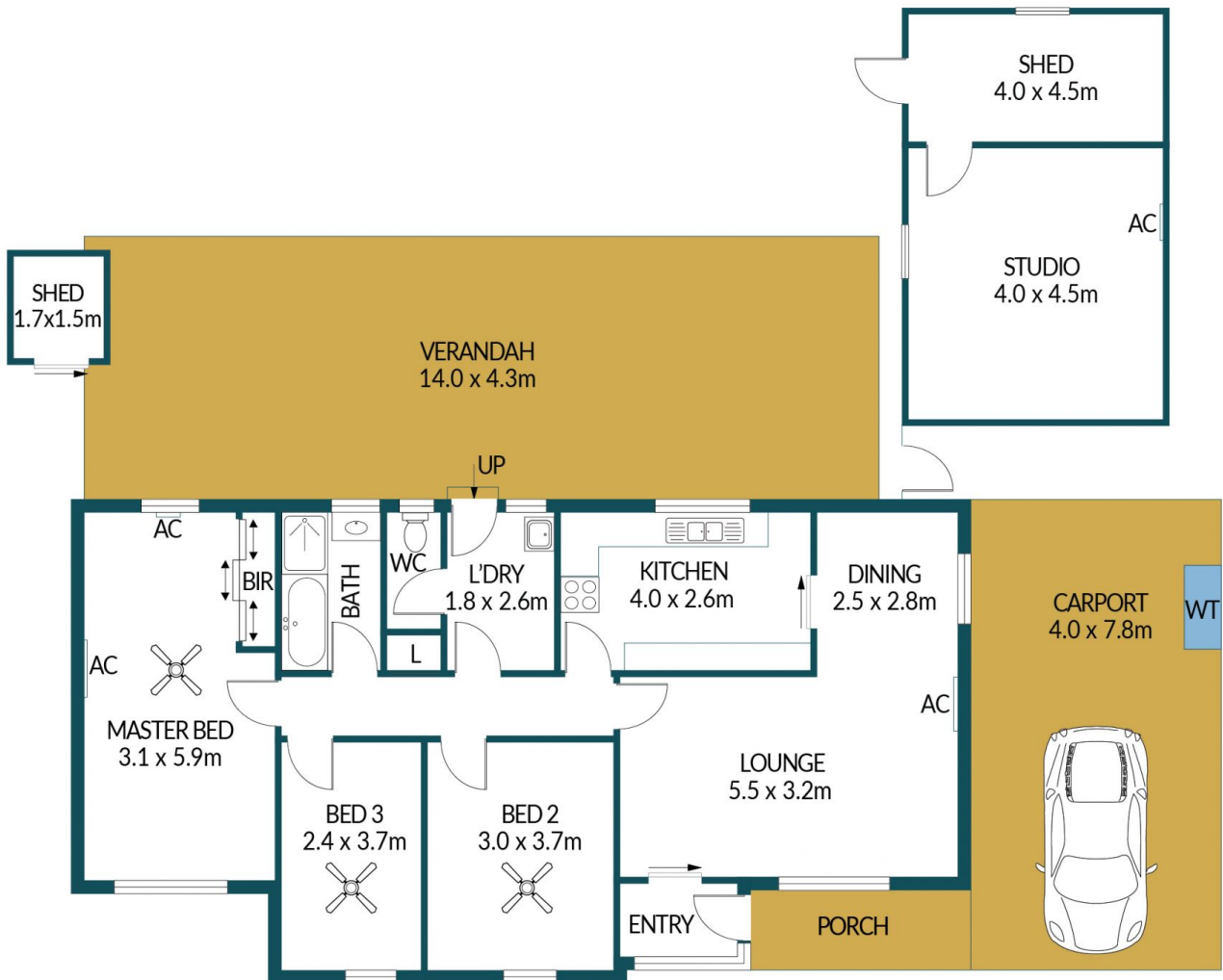

10 PRUNUS AVENUE, ELIZABETH VALE

Disclaimer

Plans shown are for marketing purposes only. All dimensions and placements are approximate and not to scale. They are subject to errors and inaccuracies and no liability will be accepted. Interested parties should make their own enquiries. Inclusions and exclusions must be confirmed in the Residential Contract.

APPROXIMATE DIMENSIONS

LIVING:	92.0m ²
SHED/STUDIO:	38.6m ²
PORCH/CARPORT:	34.0m ²
VERANDAH:	60.2m ²
TOTAL:	224.8m ²