



## 28 Butterfield Road ELIZABETH PARK SA

3 1 1

\*For an in-depth look at this home, please click on the 3D tour for a virtual walk-through or copy and paste this link into your browser\*

Virtual Tour Link: <https://shorturl.at/CdjKd>

To submit an offer, please copy and paste this link into your browser:

<https://www.edgerealty.com.au/buying/make-an-offer/>

Mike Lao, Brendon Ly and Edge Realty RLA256385 are proud to present to the market this charming maisonette, situated on a large 627sqm approx. block in the heart of Elizabeth Park, offering endless possibilities for families and savvy investors. With 3 bedrooms, 1 bathroom, a living area and a large yard, this property offers ample space for

[For full version visit the website](#)

**Type** : House  
**Price** : Under Contract!  
**Building Size** : 76 sqm  
**Land Size** : 627 sqm  
**View** : <https://www.edgerealty.com.au/sale/sa/north-north-east-suburbs/elizabeth-park/residential/house/8140305>



**Mike Lao**  
0419399359



**Brendon Ly**  
0417889444

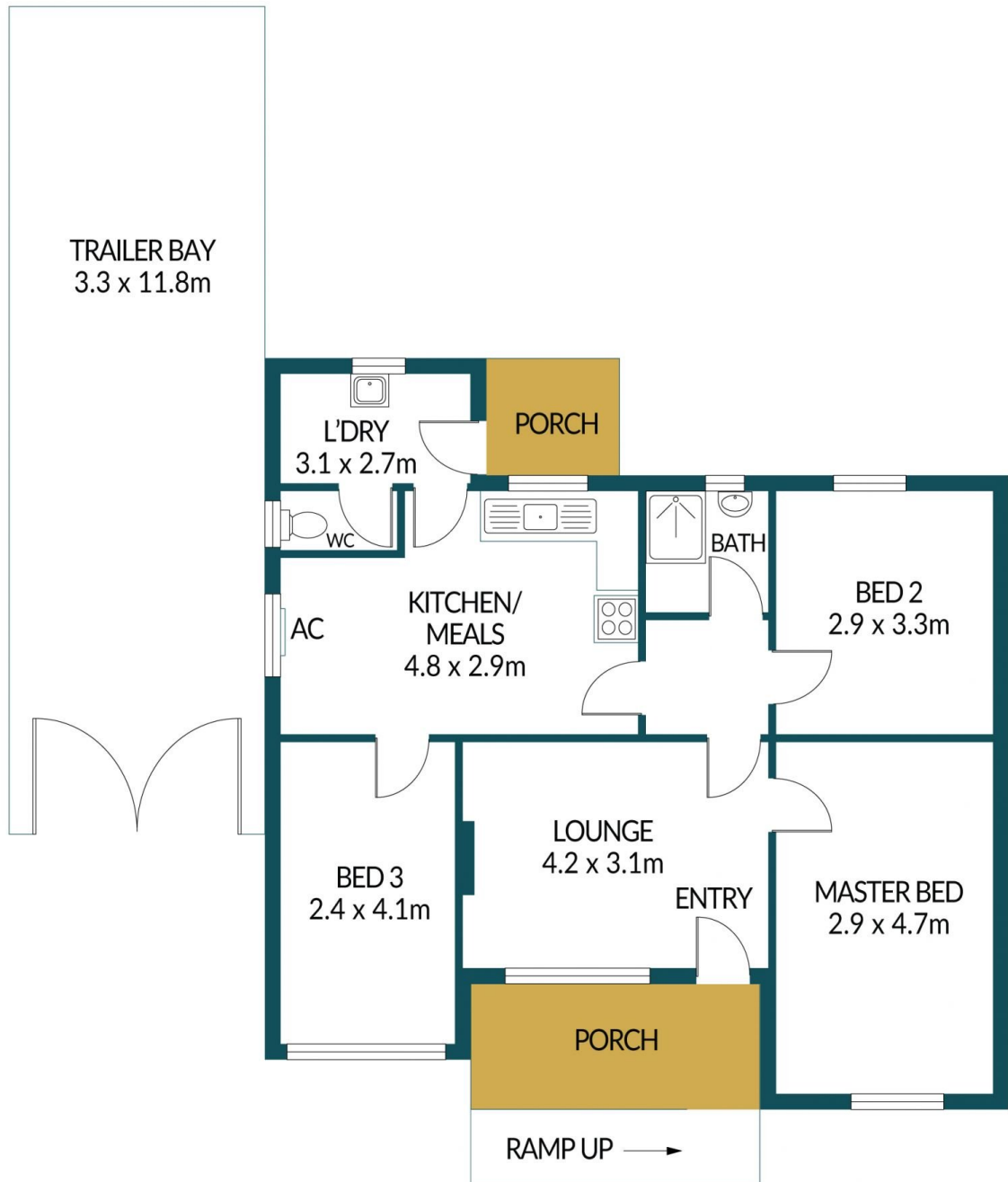

## 28 BUTTERFIELD ROAD, ELIZABETH PARK

### Disclaimer

Plans shown are for marketing purposes only. All dimensions and placements are approximate and not to scale. They are subject to errors and inaccuracies and no liability will be accepted. Interested parties should make their own enquiries. Inclusions and exclusions must be confirmed in the Residential Contract.

### APPROXIMATE DIMENSIONS

LIVING:	76.0m <sup>2</sup>
CARPORT:	38.9m <sup>2</sup>
PORCH:	13.2m <sup>2</sup>
TOTAL:	128.1m <sup>2</sup>