



## 34/6 Loades Street SALISBURY SA

2 1

\*For an in-depth look at this home, please click on the 3D tour for a virtual walk-through or copy and paste this link into your browser\*

Virtual [Tour](https://my.matterport.com/show/?m=gisMVUg5KNm) Link:

To submit an offer, please copy and paste this link into your browser:  
<https://www.edgerealty.com.au/buying/make-an-offer/>

Mike Lao, Brendon Ly and Edge Realty RLA256385 are proud to present to the market an updated solid brick two-bedroom unit, nestled in the heart of Salisbury. Perfectly situated on the first level of a well-maintained complex, this home offers modern living with unbeatable

[For full version visit the website](https://www.edgerealty.com.au)

**Type** : Unit  
**Price** : \$285,000 - \$310,000  
**Building Size** : 72 sqm  
**View** : <https://www.edgerealty.com.au/sale/sa/north-north-east-suburbs/salisbury/residential/unit/8169733>



**Mike Lao**  
0410390250



**Brendon Ly**  
0447888444

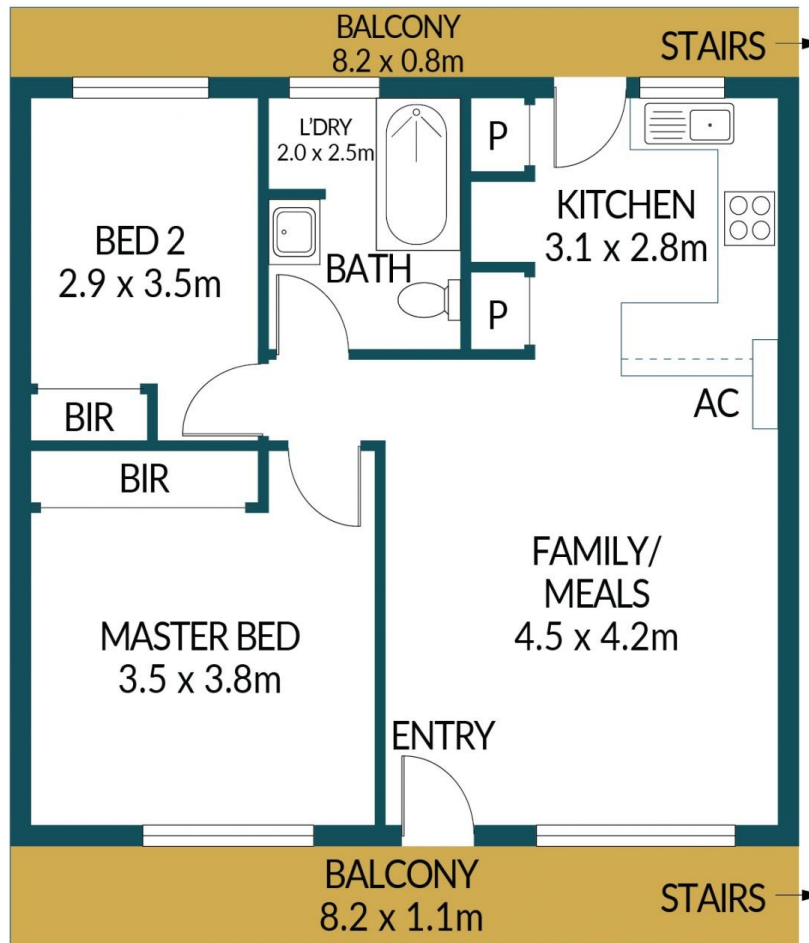

## 34/6 LOADES STREET, SALISBURY

### Disclaimer

Plans shown are for marketing purposes only. All dimensions and placements are approximate and not to scale. They are subject to errors and inaccuracies and no liability will be accepted. Interested parties should make their own enquiries. Inclusions and exclusions must be confirmed in the Residential Contract.

### APPROXIMATE DIMENSIONS

LIVING:	56.4m <sup>2</sup>
BALCONY:	15.6m <sup>2</sup>
TOTAL:	72.0m <sup>2</sup>