



11 Bristol Crescent DAVOREN PARK SA

3 1 1

For an in-depth look at this home, please click on the 3D tour for a virtual walk-through or copy and paste this link into your browser

Virtual <https://my.matterport.com/show/?m=NkdwLFNGFJm> Tour Link:

To submit an offer, please copy and paste this link into your browser:
<https://www.edgerealty.com.au/buying/make-an-offer/>

Mike Lao, Brendon Ly and Edge Realty RLA256385 are proud to present to the market 11 Bristol Crescent, Davoren Park - a low-maintenance home nestled in the thriving northern suburbs! Offering flexibility and brimming with potential, this home offers up to four bedrooms,

[For full version visit the website](https://www.edgerealty.com.au)

Type : House
Price : \$549,000 - \$599,000
Building Size : 123 sqm
Land Size : 496 sqm
View : <https://www.edgerealty.com.au/sale/sa/north-north-east-suburbs/davoren-park/residential/house/8179762>



Mike Lao
 0419300350



Brendon Ly
 0417888444

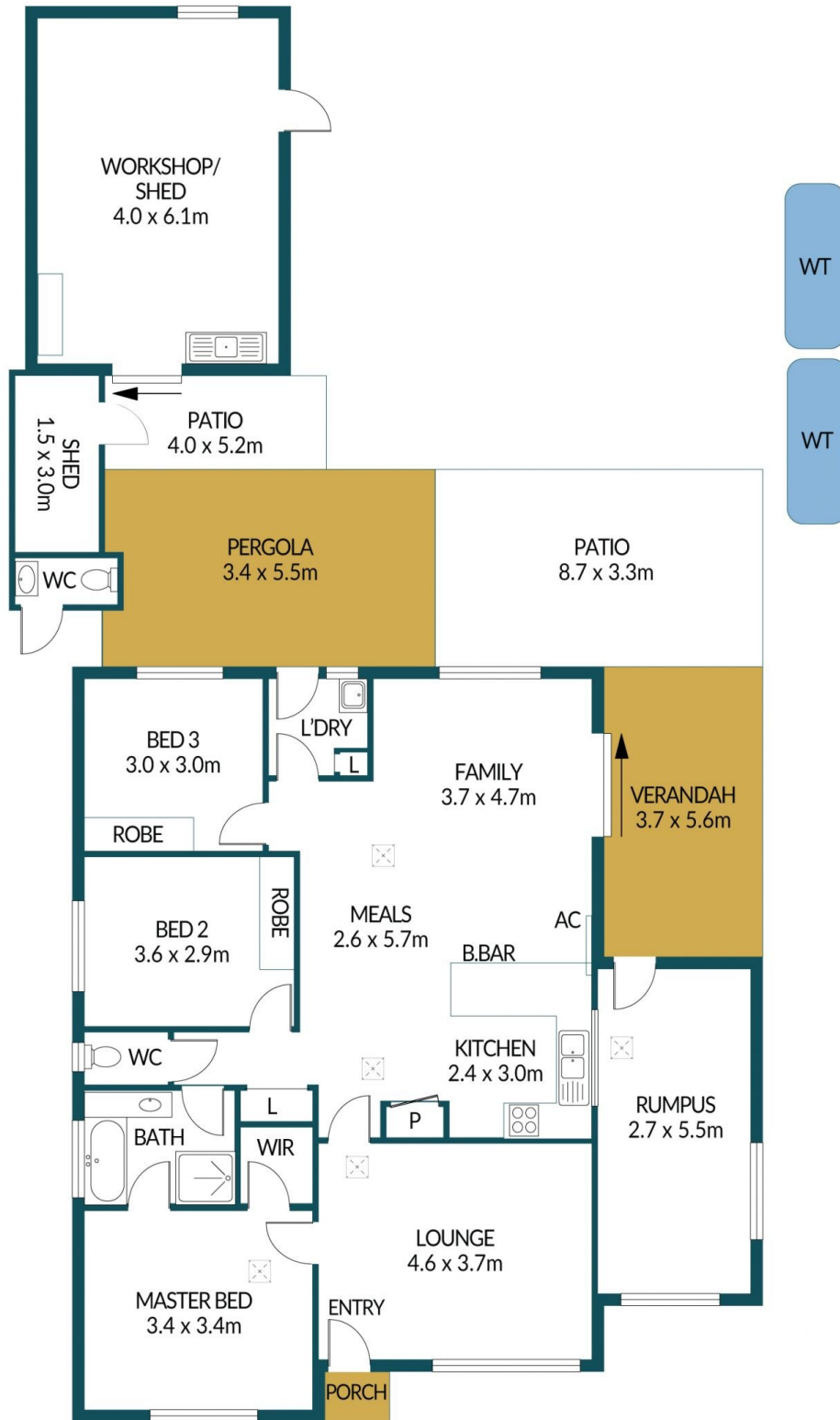

11 BRISTOL CRESCENT, DAVOREN PARK

Disclaimer

Plans shown are for marketing purposes only. All dimensions and placements are approximate and not to scale. They are subject to errors and inaccuracies and no liability will be accepted. Interested parties should make their own enquiries. Inclusions and exclusions must be confirmed in the Residential Contract.

APPROXIMATE DIMENSIONS

LIVING:	123.7m ²
VERANDAH:	20.7m ²
PATIO:	49.5m ²
PERGOLA:	18.7m ²
PORCH:	1.2m ²
WORKSHOP/SHED:	28.9m ²
TOTAL:	242.7m ²